

Licensing Sub-Committee Agenda



To: Councillors Pat Clouder, Toni Letts and Badsha Quadir

A meeting of the **Licensing Sub-Committee** which you are hereby summoned to attend, will be held on **Wednesday, 27 June 2018** at **10.30 am** in **Council Chamber - Town Hall**

JACQUELINE HARRIS-BAKER
Director of Law and Monitoring Officer
London Borough of Croydon
Bernard Weatherill House
8 Mint Walk, Croydon CR0 1EA

Kieran Pantry-Melsom
020 8726 6000 x63922
kieran.pantry-melsom@croydon.gov.uk
www.croydon.gov.uk/meetings
Tuesday, 19 June 2018

Members of the public are welcome to attend this meeting.
If you require any assistance, please contact the person detailed above, on the righthand side.

N.B This meeting will be paperless. The agenda can be accessed online at www.croydon.gov.uk/meetings

AGENDA – PART A

1. Appointment of Chair

To appoint a Chair for the duration of the meeting.

2. Apologies for Absence

To receive any apologies for absence from any members of the Committee.

3. Disclosure of Interests

In accordance with the Council's Code of Conduct and the statutory provisions of the Localism Act, Members and co-opted Members of the Council are reminded that it is a requirement to register disclosable pecuniary interests (DPIs) and gifts and hospitality to the value of which exceeds £50 or multiple gifts and/or instances of hospitality with a cumulative value of £50 or more when received from a single donor within a rolling twelve month period. In addition, Members and co-opted Members are reminded that unless their disclosable pecuniary interest is registered on the register of interests or is the subject of a pending notification to the Monitoring Officer, they are required to disclose those disclosable pecuniary interests at the meeting. This should be done by completing the Disclosure of Interest form and handing it to the Democratic Services representative at the start of the meeting. The Chair will then invite Members to make their disclosure orally at the commencement of Agenda item 3. Completed disclosure forms will be provided to the Monitoring Officer for inclusion on the Register of Members' Interests.

4. Urgent Business (if any)

To receive notice of any business not on the agenda which in the opinion of the Chair, by reason of special circumstances, be considered as a matter of urgency.

5. Licensing Act 2003: Application for a Premises Licence (Pages 5 - 50)

6. Licensing Act 2003: Variation of a Premises Licence (Pages 51 - 88)

7. Exclusion of the Press and Public

The following motion is to be moved and seconded where it is proposed to exclude the press and public from the remainder of a meeting:

“That, under Section 100A(4) of the Local Government Act, 1972, the press and public be excluded from the meeting for the following items of business on the grounds that it involves the likely disclosure of exempt information falling within those paragraphs indicated in Part 1 of Schedule 12A of the Local Government Act 1972, as amended.”

PART B

This page is intentionally left blank

Agenda Item 5

REPORT TO:	LICENSING SUB COMMITTEE 27 June 2018
AGENDA ITEM:	
SUBJECT:	LICENSING ACT 2003 – APPLICATION FOR A PREMISES LICENCE
LEAD OFFICER:	Executive Director, Place Department
CABINET MEMBER:	Cllr. Hamida Ali, Cabinet Member for Communities Safety & Justice
WARDS:	New Addington South
CORPORATE PRIORITY/POLICY CONTEXT: This report is specific to this application and has no implications on the Council's Corporate Policies.	
FINANCIAL SUMMARY: This application is being processed as part of normal duties carried out by the Department with no additional costs involved.	
FORWARD PLAN KEY DECISION REFERENCE NO.: N/A	

For general release

1. RECOMMENDATIONS

- 1.1 The Sub-Committee is asked to determine whether to grant the application for a premises licence at 12 Central Parade, New Addington, CR0 0JB.

2. EXECUTIVE SUMMARY

- 2.1 The purpose of this report is to advise the Sub-Committee that an application has been received for a premises licence under the Licensing Act 2003 ("the Act"). This application is the subject of representations, therefore a hearing is required.

3. DETAIL

- 3.1 A Protocol for Licensing Hearings and a Procedure for Licensing Sub-Committee Hearings has previously been agreed by the Licensing Committee (minute A/24/05 refers). The protocol has been subsequently amended by the licensing committee (minutes A/32/06, A/40/07 and A/07/12 refer).

- 3.2 The applicant and the parties making the representations have been notified of the hearing in accordance with the Licensing Act 2003 (Hearings) Regulations 2005 and Licensing Act 2003 (Hearings) (Amendment) Regulations 2005 “the Regulations”. Information to accompany the notice of hearing was provided to the applicant and the persons making representations in accordance with “the Regulations”.
- 3.3 Appendix A to this report provides details of this application.

4. FINANCIAL CONSIDERATIONS

1 Revenue and Capital consequences of report recommendations

There are no direct financial implications associated with this report, subject to the risks at 4.2 & 4.3. This application is being processed as part of normal duties and therefore the work associated with it is contained within the departmental budget.

2 The effect of the decision

The decision of the Sub-Committee may be subject to appeal and/or Judicial Review

3 Risks

An appeal against a decision of the Sub-Committee or a Judicial Review of the application process may present financial risks to the Council with regard to any award of costs against it.

4 Options

The options available are: to grant the application, to vary the application, with or without further conditions, or to refuse the application.

5 Savings/ future efficiencies

None identified.

6 (Approved by: Zulfiqar Darr, Interim Head of Finance, Place & Resources)

5. COMMENTS OF THE SOLICITOR TO THE COUNCIL

- 5.1 The Solicitor to the Council comments that the sub-committee must determine the application, taking into account relevant representations, the Licensing Act 2003, the regulations made thereunder statutory guidance and the Council’s own licensing policy.
- 5.2 (Approved for and on behalf of Jacqueline Harris-Baker, Director of Law & Monitoring Officer)

6. HUMAN RESOURCES IMPACT

- 6.1 The Human Resources impact of supporting the Licensing Hearings will be contained within the budgeted establishments of the Democratic and Legal Services and Licensing Teams.
- 6.2 (Approved by: Adrian Prescod, HR Business Partner, for and on behalf of Director of Human Resources, Chief Executive's Department)

7. EQUALITIES IMPACT

- 7.1 The arrangements for the Licensing Hearings seek to ensure that all applicants and other interested parties receive a fair hearing and that the process is accessible to all groups within the community.

8. ENVIRONMENTAL AND DESIGN IMPACT

- 8.1 The effective implementation of the Licensing Act 2003 will contribute to an improved environment for local residents and other stakeholders.

9. LICENSING OBJECTIVES IMPACT

- 9.1 The licensing objectives contained in the Act are:
- the prevention of crime and disorder
 - public safety
 - the prevention of public nuisance and
 - the protection of children from harm.
- 9.2 Officers comments and relevant representations on the impact of the application on these objectives appear in Appendix A to the application.

10. HUMAN RIGHTS IMPACT

- 10.1 The Human Rights 1998 (HRA) requires public bodies to ensure everything they do is compatible with Convention Rights and makes it unlawful for a public authority to act incompatibly with those Rights. **Article 6 (A6)** of the European Convention on Human Rights (ECHR) is the right to a fair trial. The key elements of this include:
- The right to a *fair* hearing;
 - The right to a *public* hearing;
 - The right to a hearing before an *independent and impartial tribunal*;
 - The right to a hearing *within a reasonable time*.
- 10.2 When hearing an application, the proceedings of a non-judicial body such as the Licensing Sub Committee, as opposed to an actual Court, need not meet the full requirements of A6 where there is a right of appeal from the Licensing Sub Committee to a Court that does meet the full A6 standards and can consider all aspects of the case (even if that does not include a full re-hearing of the facts).

10.3 So, while it is good practice to make a hearing before the Licensing Sub Committee as A6 compliant as possible, it will not be a breach of the HRA if it is not. Further, the hearing of all applications is subject to the principles of Natural Justice and the requirement for decisions to be 'Wednesbury reasonable'.

11. FREEDOM OF INFORMATION/DATA PROTECTION CONSIDERATIONS

11.1 Protocols agreed in relation to Licensing Hearings are within the Council's Constitution and will be accessible as part of the Council's Publication Scheme maintained under the Freedom of Information Act.

CONTACT OFFICER: Michael Goddard, Licensing Manager, Place
Department ext. 61838

BACKGROUND DOCUMENTS: Application Forms
Licensing Hearings and Protocol and Procedure

APPENDIX A

1. The Application

1.1 This report concerns an application by Reshma Talwar for a premises licence at 12 Central Parade, New Addington, CR0 0JB.

1.2 The application seeks the following licensable activity between the hours shown –

The Sale by Retail of Alcohol –

Monday to Sunday 0800 hours until 2200 hours

1.3 The relevant pages of the application are attached at Appendix A1

1.4 Would the sub committee please note that, following discussions with the Police licensing officer, the applicant has amended their application to have the following conditions placed on the premises licence, should the application be granted –

The premises licence holder shall:

1. Install and maintain a CCTV system to comply with Home Office Requirements for CCTV systems 2009, covering the entrances, exits, internal areas of the premises and recordings shall be stored for a minimum of 28 days and CCTV images shall be delivered to Police or Council Officer on request.
2. CCTV cameras shall be installed at the entrance door to enable head and shoulders images to identification standard, of each person entering, to be captured as they enter the premises.
3. A member of staff trained in the use of the CCTV system must be available at the premises at all times that the premises are open to the public.
4. The system will display, on screen and any recording, the correct time and date of the images and recording.
5. Ensure that a Challenge 25 policy is operated at the premises with appropriate signage displayed inside and outside the premises.
6. Ensure that CCTV signage is displayed reminding customers that CCTV is in operation.
7. Ensure that all staff within the business are trained in relation to the Licensing Act 2003 and training records shall be available for Inspection

by the police upon request. Refresher training will be undertaken every 6 Months.

8. Ensure alcohol is displayed away from the front entrance to the premises. All spirits shall be kept out of public reach behind the counter.

9. A comprehensive incident register shall be maintained, at the premises. The DPS shall ensure that the details of incidents shall be added to the register within 24 hrs of any incident. The following details shall be recorded:-

Date

Time

Location

Persons concerned

Summary of incident

Identification of any Emergency Services Personnel who attended

10. Ensure that a refusals book or electronic system to record all refusals of sales shall be maintained on the premises and made available to the police and local authority upon request.

11. Ensure that no Beer, Cider or Perry is stocked, exposed for sale or sold that exceeds 6.5% ABV.

1.5 I can confirm that the application premises do fall within a Cumulative Impact Zone/Area as defined by the Council's Licensing Policy. See Para. 4.23 iv below under Policy Considerations

2 Promotion of Licensing Objectives

2.1 The applicant provides details in Section 18 on their application of the steps they intend to take to meet the four licensing objectives. These steps would in turn, where applicable, be made into conditions to be attached to the licence, if granted.

3 Relevant representations

3.1 Representations have been received on this application. Copies are attached at Appendix A2.

3.2 The applicant has been provided with a written copy of the representations made.

4 Policy Considerations

4.1 Under the terms of the Act, the Council has published a Statement of Licensing Policy. This is available on the Council website at www.croydon.gov.uk. Hard copies are also available from the Council's Place Department and copies of the policy will also be available at the licensing sub committee hearing. The following paragraphs

from the Statement are considered particularly relevant with regard to this application.

4.8 The fundamental principles of the Act and its accompanying guidance are that nothing in this 'Statement of Policy' will:

undermine the rights of any person to apply under the 2003 Act for a variety of permissions and have each application considered on its individual merits, or, override the right of any person to make representations on any application or seek a review of a licence or certificate where they are permitted to do so under the 2003 Act.

4.9 Parties should be aware that, for a representation to be considered relevant, it must be one that is about the likely effect of the grant of a new licence/certificate or variation of an existing licence/certificate on the promotion of the four licensing objectives. Also, if the representation is made by an 'other person', it will not be relevant if the licensing authority considers it to be 'vexatious or frivolous', or in the case of a review, 'repetitious'.

4.10 Applicants and those making relevant representations in respect of applications or seeking a review of a licence or a certificate have the right of appeal to the Magistrates' Court against the decisions of the Council.

4.11 In considering all licence/certificate applications, the Council will take into account the character of the surrounding area, the impact of the licence/certificate on that area and the nature and character of the operation.

4.12 As part of any application for a premises licence/club premises certificate or a variation to an existing licence/certificate, applicants are required to submit an 'Operating Schedule', which must include the steps proposed to promote the Licensing Objectives set out in paragraph 2.2.

4.13 Part 5 of this Statement gives guidance to applicants on some of the matters they may wish to consider when preparing their Operating Schedules.

4.14 Licensing is about permitting activities but also ensuring the responsible management of licensed premises, qualifying clubs and temporary events within the terms of the 2003 Act, and conditions are likely to be attached to licences, certificates and permissions that will cover matters which are within the control of individual licensees.

4.15 However, the Council acknowledges that it can only impose conditions where relevant representations have been received on an application and that such conditions must be considered necessary for the promotion of the licensing objectives. Where no relevant representations have been made, the application will be granted by the licensing authority in terms consistent with the applicants operating schedule.

4.16 When considering these conditions, the Council will primarily focus on the direct impact of the activities taking place at licensed premises on members

of the public living, working or engaged in normal activity in the area concerned.

NEED and CUMULATIVE IMPACT

- 4.17 The Council will not take 'need' into account when considering an application, as this concerns 'commercial demand' and is a matter for the planning process and the market.
- 4.18 However, the Council recognises that a significant number and type of licensed premises in a particular area may lead to problems of crime, disorder and nuisance and notes that in accordance with the Statutory Guidance to the Act, their cumulative impact on the promotion of the licensing objectives is a proper matter for the Council to consider. For example, national analysis of alcohol sales data (sales in the on and off trade) has shown a positive association at local authority level between off-trade sales and alcohol-specific hospital admissions.
- 4.19 Where the Council recognises that there is such a cumulative effect it will consider adopting a specific Cumulative Impact Policy for that area, if this is shown to be necessary. Reducing availability, affordability and attractiveness are some of the most effective ways to reduce alcohol-harm and related crime.
- 4.20 In these circumstances, the Council may consider that the imposition of conditions is unlikely to address the apparent problems and may consider the adoption of a special policy whereby there will be a presumption that new premises licence or club premises certificate applications, or applications to materially vary a premises licence, will be refused. A material variation may be, for example, an increase in permitted hours or to add a licensable activity onto a premises licence.
- 4.21 Based on the Statutory Guidance to the Act, in deciding whether to adopt such a Policy in an area, the Council will consider the following:
- local crime and disorder statistics, including statistics on specific types of crime and crime hotspots
 - statistics on local anti-social behaviour offences
 - the density and number of current premises selling alcohol
 - Alcohol use and misuse in Croydon's population
 - Claimants of benefits due to alcoholism
 - Alcohol specific hospital admissions for under 18's
 - Ambulance incidents and dispatches
 - Alcohol related road traffic accidents
 - Statistics on alcohol related emergency attendances and hospital admissions
 - Mortality
 - Complaints recorded by the local authority
 - Evidence from local councillors and
 - Evidence obtained through local consultation.

- 4.22 There are concerns about parts of the borough which experience high levels of alcohol related crime and alcohol related hospital admissions and where it is clear that the density of shops selling alcohol for consumption off the premises is significantly higher than in other parts of the borough.
- 4.23 As a result, the Council has considered it appropriate to designate, the following four areas within Croydon as being subject to a special Cumulative Impact Policy in respect of off licences and shops and supermarkets selling alcohol off the premises:
- i. Along the Brighton Road; South End; High Street, George Street corridor, from the Royal Oak Centre on Brighton Road, Purley to the junction of George Street and Cherry Orchard Road in Central Croydon
 - ii Along the London Road/Streatham High Road corridor, in 3 sections; from the junction of London Road and Tamworth Road in West Croydon to the j/w Canterbury Road; from the j/w Broughton Road to the j/w Melrose Avenue and; from the j/w Northborough Road to the borough boundary with London Borough of Lambeth
 - iii Along the Brigstock Road and High Street, Thornton Heath corridor, from the junction of Brigstock Road and London Road in Thornton Heath to the junction of High Street, Thornton Heath and Whitehorse Lane
 - iv Along the length of Central Parade, New Addington
- 4.24 The effect of a Cumulative Impact Zone Policy for each of the areas listed above is that where relevant representations are received on any new applications for a premises licence to sell alcohol off the premises, or on a material variation to an existing such premises licence there will be a presumption under the special policy that the application will be refused. A material variation would be, for example, an increase in permitted hours for the sale of alcohol or to add the sale of alcohol off the premises as a licensable activity to the premises licence.
- 4.25 The Cumulative Impact Policy is intended to be strict, and will only be overridden in genuinely exceptional circumstances. However, the Licensing Authority will not apply these policies inflexibly. It will always consider the individual circumstances of each application; even where an application is made for a proposal that is apparently contrary to policy.
- 4.26 It is not possible to give a full list of examples of when the council may treat an application as an exception. However, in considering whether a particular case is exceptional, the Licensing Authority will consider the reasons underlying the policy.
- 4.27 The Licensing Authority will not consider a case to be exceptional merely on the grounds that the premises have been or will be operated within the terms of the conditions on the licence, or that are or will be generally well managed because of the reputation or good character of the licence holder or operator.

This is expected in the conduct of all licensed premises. Moreover, licences are for premises and can be easily transferred to others who intend to operate within the scope of the licence and its conditions.

- 4.28 The Council will review the special policies regularly to see whether they have had the effect intended and whether they are still needed or whether they need expanding.
- 4.29 The Council will not use these policies solely:
- As the grounds for removing a licence when representations are received about problems with existing licensed premises, or,
 - To refuse modifications to a licence, except where the modifications are directly relevant to the policy, for example where the application is for an extension in permitted hours or to add a licensable activity.
- 4.30 The Council recognises though that where no relevant representations are made in relation to an application in a cumulative impact area, the application must be granted in terms consistent with the applicants operating schedule.
- 4.31 The Council recognises that the diversity of premises selling alcohol, serving food and providing entertainment covers a wide range of contrasting styles and characteristics and will have full regard to those differences and the differing impact these will have on the local community.
- 4.32 Where an application is made for a new or transfer and variation of a licence, in respect of premises that have closed and been unused and that closure was to a relevant extent as a consequence of crime and disorder and/or nuisance issues at the premises, the Council would expect the applicant to make clear in their operating schedule how they will ensure the crime and disorder and public nuisance objectives will be met, bearing in mind any previous crime and disorder/nuisance concerns there may have been.
- 4.33 It therefore also recognises that, within the Cumulative Impact Policy areas, it may be able to approve licences that are unlikely to add significantly to the existing problems, and will consider the circumstances of each individual application on its merits.
- 4.34 In addition to the cumulative impact zones listed above, the Council is aware of concerns amongst responsible authorities and residents about the number of shops licensed to sell alcohol for consumption off the premises in certain other areas of the borough and the impact they may be having on crime and disorder. It is not intended at this time to introduce cumulative impact zones in these areas, however, they will be monitored and assessed regularly and should concerns increase, consideration will given to formally identifying them as cumulative impact zones. For the time being, those areas will be classed as special stress areas and they are as follows:
- High Street & Portland Road, South Norwood
 - Lower Addiscombe Road

- 4.35 The Council acknowledges that the licensing function cannot be used for the general control of anti-social behaviour by individuals once they are beyond the direct control of the licensee of any premises concerned and that apart from the licensing function, there are a number of other measures available for addressing issues of unruly behaviour that can occur away from licensed premises.
- 4.36 In recognising the importance of such measures, the Council will continue to seek further improvements to those already achieved in respect of planning controls and working in partnership with local businesses and transport operators on a number of measures to create a safe and clean environment in the following areas:
- Provision of extensive CCTV and radio communication systems
 - Improvements to street lighting
 - Rubbish collection and street cleaning
 - Provision of better late night bus, tram, rail and taxi/minicab services
 - Provision of Police Officers/street and litter wardens
 - Designation of areas within the borough, as part of a Public Space Protection Order, where alcohol may not be consumed publicly and monitoring the possible need for future designations in other parts of the borough*
 - Working in partnership with Croydon Borough Police on law enforcement issues relating to disorder and anti-social behaviour. These include the use of powers to issue fixed penalty notices, prosecuting those selling alcohol to people who are underage and/or drunk, confiscating alcohol from adults and children in designated areas and instant closure of licensed premises or temporary events on the grounds of disorder, or likelihood of disorder or excessive noise from the premises
 - Working in partnership with Licensees and expecting them to support existing and future agreed measures set up to promote the strategic objectives for crime and disorder reduction within the Borough
 - Acknowledging the powers of the police or other responsible authorities, or a local resident or business under the 2003 Act, to seek a review of the licence or certificate

*Would existing licence/certificate holders and new applicants please note that a number of areas within the borough of Croydon are to lie within Public Space Protection Orders (PSPO's) that may control the consumption of alcohol in public areas. Please contact the Council's licensing team if you wish to discuss how such orders may affect licensed premises.

5. LICENSING OBJECTIVES and OPERATING SCHEDULES

- 5.1.1 The following sections set out the Council's Policy relating specifically to the four Licensing Objectives:
- the prevention of crime and disorder
 - public safety
 - the prevention of public nuisance

- the protection of children from harm
- 5.1.2 In each section the Council defines its intended outcome and lists the factors that may influence achieving that particular objective, but because of the wide variety of premises and activities to which this Policy applies, the lists provided are not exhaustive. Applicants will know their premises best and will be expected to address all aspects relevant to the individual style and characteristics of their premises and events.
- 5.1.3 Further, each section lists possible control measures to assist applicants, but again these lists are not exhaustive. Also, many of the control measures achieve more than one Objective but have not been listed under each Objective and applicants do not need to mention a control measure more than once in their Operating Schedule.

5.2 Crime and Disorder

- 5.2.1 Croydon Council is committed to reducing crime and disorder within the Borough and creating an environment where people feel safe.
- 5.2.2 In addition to the requirements under the 2003 Act for the Council to promote the licensing objective of preventing crime and disorder, it also has a duty under Section 17 of the Crime and Disorder Act 1998 to do all it reasonably can to prevent crime and disorder in the Borough.
- 5.2.3 Licensed premises, especially those offering late night/early morning entertainment, alcohol and/or refreshment, can be a source of crime and disorder problems.
- 5.2.4 The Council considers that the promotion of the Licensing Objective to prevent crime and disorder also places a responsibility on licence holders to work in partnership to achieve this Objective.
- 5.2.5 The Council will expect applicants to demonstrate in their Operating Schedule that suitable and sufficient measures have been identified and will be implemented and maintained so as to minimise or prevent crime and disorder in and around the vicinity of their premises and events.
- 5.2.6 The Licensing Authority recommends that for certain events, a comprehensive risk assessment is undertaken by premises licence applicants & holders to ensure that crime and disorder and public safety matters are identified and addressed. For larger public events, including those in open spaces and for premises that wish to stage promotions or events, the Licensing Authority recommends that licence applicants and holders address Risk Assessment

and post event debrief processes in their application operating schedule/event planning.

5.2.7 Applicants and premises licence holders may wish to engage the services of suitably trained individuals or companies to assist them in this risk assessment process. In addition, they may seek guidance and advice from the Licensing Authority or the Metropolitan Police regarding the process, although the responsibility for undertaking the risk assessment remains with the Applicant/Premises License holder as neither body is able to actually undertake such risk assessments for applicants/licence holders. Applicants and premises licence holders are also reminded that the Licensing Authority is not able to recommend the services of a particular individual or company for this purpose.

5.2.8 Drugs, violence, anti social behaviour and theft of customers property are examples of crime and disorder issues which may be addressed by the following examples of recommended management practice being included in operating schedules, having due regard to the type of premises and/or activities:

- effective and responsible management and supervision of the premises, including associated open areas, appropriate storage of alcohol, discouraging loitering/consuming alcohol outside the premises, ensuring opening hours are adhered to
- participation in responsible management schemes such as the 'Best Bar None' accreditation/award scheme
- appropriate instruction, training and supervision of those employed or engaged to prevent incidents of crime and disorder
- adoption of existing and future best practice guidance (e.g. Safer Clubbing, the National Alcohol Harm Reduction Toolkit and other recognised codes of practice including those relating to drinks' promotions, i.e. The Point of Sale Promotions published by the British Beer and Pub Association and cheap drinks deals/Happy Hours)
- acceptance of accredited 'proof of age' documentation, as recognised by the Council in consultation with the Police
- maintaining appropriate signage and a refusals log
- employment of sufficient SIA licensed door staff, i.e. within nationally accepted standards
- provision of toughened or plastic glasses
- provision of secure deposit boxes for confiscated items as recognised by the Council in conjunction with the Police
- provision of litter bins and security measures, such as lighting outside premises
- Other schemes including only purchasing alcohol from authorised wholesalers, not selling certain alcohol types/strengths (e.g. high strength beers/ciders or single cans above 6% ABV), restricting sales on certain alcohol types (e.g. miniature spirits), allowing a 'track and trace' identifier on products so Police/Trading Standards can identify which off-

licence seized alcohol is from, signing up to local responsible retailer schemes

- Provision of closed circuit television, with cameras covering relevant internal and external areas (including beer gardens) and entrances/exits to premises

Note: As this Policy applies to a wide range of premises and activities, the above list will not be applicable in all cases and in some cases additional matters may need addressing.

5.2.9 Additionally, when preparing their Operating Schedules, applicants are recommended to seek advice from the Council Licensing Team and Croydon Police Licensing and/or Crime Prevention Officers, as well as taking into account, as appropriate, local planning and transport policies, and, tourism, cultural and crime prevention strategies.

5.2.10 Where relevant representations have been made, the Council will consider attaching conditions to licences and permissions to deter and prevent crime and disorder both inside and immediately outside the premises.

5.3 Public Safety

5.3.1 The Council is committed to ensuring that the safety of any person visiting or working in licensed premises is not compromised. To this end, applicants will be expected to demonstrate in their Operating Schedule that suitable and sufficient measures have been identified and will be implemented and maintained to ensure public safety, relevant to the individual style and characteristics of their premises and events.

5.3.2 The 2003 Act covers a wide range of premises that require licensing, including, cinemas, concert halls, theatres, nightclubs, public houses, off licences, cafés/restaurants, fast food outlets/takeaways and sometimes open spaces.

5.3.3 Each of these types of premises present a mixture of different risks, with many common to most premises and others unique to specific operations. These will range from fire safety, including fire precautions and means of escape arrangements in all types of premises, to the use of scenery and pyrotechnics in theatres and special lighting effects in night clubs.

5.3.4 It is essential that premises are constructed or adapted and operated so as to acknowledge and safeguard occupants against these risks.

5.3.5 The following examples of influencing factors are given to assist applicants when addressing the issue of public safety during the preparation of their Operating Schedule:

- the number of people attending the premises
- the condition, design and layout of the premises, including the means of escape in case of fire

- the nature of the activities to be provided, in particular the sale of alcohol and including whether those activities are of a temporary or permanent nature
 - the hours of operation and hours of opening if different
 - customer profile (i.e. age, mobility)
 - the use of special effects such as strobe lighting, lasers, pyrotechnics, smoke machines, foam machines etc.
- 5.3.6 Public safety issues may be addressed by the following examples of recommended management practice being included in operating schedules, having due regard to the type of premises and/or activities:

- effective and responsible management of premises
- provision of a sufficient number of people employed or engaged to secure the safety of everyone attending the premises or event, i.e. number of door supervisors within nationally accepted standards (and having SIA accreditation where necessary)
- appropriate instruction, training and supervision of those employed or engaged to secure the safety of everyone attending the premises or event
- suitable customer-care policies for assisting lone customers taken ill or injured etc. at the premises
- provision of effective CCTV in and around premises
- provision of toughened or plastic glasses
- implementation of crowd management measures
- regular testing (and certification where appropriate) of procedures, appliances, systems etc. pertinent to safety codes and standards

Note: As this Policy applies to a wide range of premises and activities, the above list will not be applicable in all cases and in some cases additional matters may need addressing.

5.3.8 Additionally, when preparing their Operating Schedules, applicants are recommended to seek advice from the Council's Health and Safety Officers and the London Fire Brigade.

5.3.9 The Council will consider attaching Conditions to licences and permissions to promote public safety.

5.4 Prevention of Public Nuisance

5.4.1 The Council recognises the need to protect the amenities of people living, visiting and working in the vicinity of licensed premises, whilst balancing the rights of businesses to develop.

5.4.2 Licensed premises, especially those operating late at night and in the early hours of the morning, can give rise to a range of public nuisances which may impact adversely on local communities.

- 5.4.3 These concerns mainly relate to noise and disturbance, light pollution, noxious smells, litter and anti-social behaviour and due regard will be taken on the impact these may have.

LICENSING HOURS

- 5.4.4 The Council will generally deal with the issue of licensing hours having due regard to the individual merits of each application, considering the potential for nuisance associated with the style, characteristics and activities of the business and examining any steps that might reduce the risk of nuisance.
- 5.4.5 The Council recognises that longer licensing hours for the sale of alcohol will avoid concentrations of people leaving premises at the same time, which is necessary to reduce the potential for friction at late night fast food outlets, taxi ranks/minicab offices and other sources of transport that can lead to disorder and disturbance.
- 5.4.6 The Council will not set fixed trading hours within designated areas (“zoning”) as it recognises this could lead to significant movements of people across boundaries at particular times seeking premises opening later and would lead to the peaks of disorder and disturbance the Council is trying to avoid. Additionally, this would seemingly treat residents in one area less favourably than those in another.
- 5.4.7 However, although the Council will treat each case on its individual merits, generally it will not grant permission for licensable activities beyond 2330 hours on Sundays to Thursdays and Midnight on Fridays and Saturdays in respect of public houses situated in areas having denser residential accommodation. The Council would expect good reasons to be given to support any application for extensions beyond these hours, including addressing possible disturbance to residents and local parking. Additionally, in these areas, consideration will be given to imposing stricter conditions in respect of noise control.

SHOPS, STORES AND SUPERMARKETS

- 5.4.8 The Council acknowledges that the Guidance issued under section 182 of the Licensing Act 2003 states that shops, stores and supermarkets should normally be free to provide sales of alcohol for consumption off the premises at any times when the retail outlet is open for shopping unless there are good reasons, based on the licensing objectives, for restricting those hours.
- 5.4.9 However, there is local concern about crime and disorder associated with shops licensed to sell alcohol off the premises. Accordingly, while the Council will treat each case on its individual merits there will be a presumption that permitted hours for the sale of alcohol will be restricted to between 8am and 11.30pm on Sunday to Thursday and 8am to midnight on Friday and Saturday in respect of shops in residential areas or within one of the four relevant Cumulative Impact Zones where representations are made by the police and/or local residents and where premises are shown to be a focus of crime,

disorder or nuisance. Applications to vary the permitted hours for the sale of alcohol off the premises within the above hours shall similarly be treated on their merits

PREVENTION OF PUBLIC NUISANCE - GENERALLY

5.4.10 The Council will expect applicants to demonstrate in their Operating Schedule that they have identified satisfactory measures and will implement and maintain these so as to prevent public nuisance, having due regard to the style, characteristics and activities of their particular premises and events and of the locality.

5.4.11 The following examples of influencing factors are given to assist applicants when addressing the issue of the prevention of public nuisance during the preparation of their Operating Schedule:

- the location of the premises and proximity to residential or other noise sensitive premises
- effective and responsible management and supervision of the premises and associated open areas
- the hours of opening
- the nature of the activities to be provided and their location within the premises, the customer profile, whether the activities are temporary or permanent and whether they are to be held inside or outside
- the design and layout of the premises and in particular the presence of noise limiting features
- the number of people attending the premises
- the availability of public transport
- a 'wind down' period between the end of the licensable activities and the closure of the premises
- a 'last admission time' policy

5.4.12 Public nuisance issues may be addressed by the following examples of recommended management practice being included in operating schedules, having due regard to the type of premises and/or activities:

- effective and responsible management and supervision of the premises, including any outside areas
- appropriate instruction, training and supervision of staff to prevent public nuisance
- adoption of current best practice guidance (i.e. Good Practice Guide on the Control of Noise from Pubs and Clubs produced by the Institute of Acoustics), including designing shop fronts so as to limit noise nuisance from premises, i.e. from opening windows or continental-style concertina doors
- control of opening hours for all or part (i.e. garden areas) of the premises – including other times when deliveries take place/rubbish and bottles are binned – and the operation of generating plant and equipment

- installation of acoustic insulation, suitably controlled, sited and silenced ventilation or air conditioning systems and sound insulation and limiting devices
- managing people, including staff and traffic, arriving and leaving the premises, including patrolling entrance queues
- managing the departure of customers
- liaising with transport providers
- siting and operation of necessary external lighting, including security lighting, with the possible nuisance to nearby properties
- suitable arrangements for collection and disposal of litter, including bottles, so as to minimise disturbance to nearby properties
- no flyposting of events/careful distribution of flyers, including by promoters
- effective ventilation systems to prevent nuisance from odour

Note: As this Policy applies to a wide range of premises and activities, the above list will not be applicable in all cases, and in some cases additional matters may need addressing.

5.4.13 Additionally, when preparing their Operating Schedules applicants are recommended to seek advice from Council Pollution Enforcement Officers.

5.4.14 The Council will consider attaching Conditions to licences and permissions to prevent public nuisance.

5.5 Protection of Children from Harm

ACCESS TO LICENSED PREMISES

5.5.1 The wide range of premises that require licensing means that children can be expected to visit many of these, often on their own, to buy food and/or for entertainment.

5.5.2 Although the 2003 Act details certain age and/or time limitations on the admission of accompanied or unaccompanied children to certain types of licensed premises, the Council recognises that additional limitations may have to be considered where it appears necessary to protect them from physical, moral or psychological harm.

5.5.3 The Council will consider the merits of each application before deciding whether to impose conditions limiting the access of children to individual premises.

5.5.4 While no policy can anticipate every situation, the following are examples of premises that will raise concern:

- where entertainment or services of an adult or sexual nature is commonly provided;

- where there have been convictions of members of the current staff at the premises for serving alcohol to minors or with a reputation for underage drinking;
- with a known association with drug taking or dealing;
- where there is a strong element of gambling on the premises (but not, for example, the simple presence of a small number of cash prize gaming machines); and
- where the supply of alcohol for consumption on the premises is the exclusive or primary purpose of the services provided at the premises.

5.5.5 When dealing with a licence application where limiting the access of children is considered necessary, the Council may consider any of the following options, in combination where appropriate:

- limitations on the hours when children may be present;
- limitations on the exclusion of the presence of children under certain ages when particular specified activities are taking place;
- limitations on the parts of premises to which children might be given access;
- age limitations (below 18);
- requirements for an accompanying adult (including for example, a combination of requirements which provide that children under a particular age must be accompanied by an adult); and
- full exclusion of people under 18 from the premises when any licensable activities are taking place.

5.5.6 The Council will not impose conditions on licences or certificates requiring that children be admitted to any premises and, where no limitation is imposed, this will be left to the discretion of the individual licensee. However, where applicants volunteer prohibitions and limitations in their operating schedules and no relevant representations have been made to the Council, these will become conditions attached to the licence/certificate conditions and will be enforceable as such.

RESPONSIBLE AUTHORITY

5.5.8 The Council recognises the Croydon Children’s Safeguarding Board and any successor groups to be the ‘responsible authority’ competent to advise on matters relating to the ‘protection of children from harm’, and to whom copies of applications should be sent.

CHILDREN IN LICENSED PREMISES – GENERALLY

5.5.13 The Council will expect applicants to demonstrate in their Operating Schedule that suitable and sufficient measures have been identified and will be implemented and maintained to protect children from harm, having due regard to the style, characteristics and activities of their particular premises and/or events.

5.5.14 Whilst children may be adequately protected from harm by the action taken to protect adults, they may also need special consideration and no policy can anticipate every situation. Applicants should consider the following influencing factors, for which there is the potential for children to be exposed, when addressing the issue of protecting children from harm during the preparation of their Operating Schedule:

- drugs, drug taking or drug dealing
- gambling
- activities of an adult or sexual nature
- incidents of violence or disorder
- environmental pollution such as noise or smoke
- special hazards such as falls from heights
- opportunities to purchase, acquire or consume alcohol

Note: A number of these factors are listed in more details in paragraph 5.5.6, but as this Policy applies to a wide range of premises and activities, the above list will not be applicable in all cases, and in some cases additional matters may need addressing.

5.5.15 Protection of children from harm issues may be addressed by the following examples of recommended management practice being included in operating schedules, having due regard to the type of premises and/or activities:

- effective and responsible management of premises
- provision of a sufficient number of people employed or engaged to secure the protection of children, including child performers, from harm
- appropriate instruction, training and supervision of those employed or engaged to secure the protection of children from harm
- adoption of best practice guidance (Public Places Charter)
- limitations on the hours when children may be present in all or parts of the premises
- limitations or exclusions by age when certain activities are taking place
- imposition of requirement for children to be accompanied by an adult
- appropriate instruction and training for counter staff in the prevention of underage sales, including acceptance of accredited 'proof of age' identification, such as a photo card driving licence, a passport, a citizens card, a validate card or a scheme which carries the PASS hologram logo and keeping a 'refusal' book.

5.5.16 Additionally, when preparing their Operating Schedules, applicants are recommended to seek advice from Council Licensing and Child Protection Officers.

5.5.17 The Council will consider attaching Conditions to licences and certificates to protect children from harm.

5.5.18 While the Council expects Licence holders to comply with the law, the 2003 Act details a number of specific offences designed to protect children in

licensed premises and the Council will work closely with the police to ensure the appropriate enforcement of the law, especially relating to the underage sale and supply of alcohol to children.

6. INTEGRATING STRATEGIES and AVOIDING DUPLICATION

6.1 There are many stakeholders in the leisure industry covering a wide range of disciplines and although their strategies are not always directly related to the promotion of the licensing objectives, they often indirectly impact upon them.

6.2 The Council therefore acknowledges the importance of co-ordinating and integrating these policies, strategies and initiatives and will maintain multi-disciplinary working groups to ensure its licensing policy integrates with local crime prevention, planning, transport, tourism, race equality schemes and cultural strategies, as well as any other plans relating to the management of the town centre and the night-time economy.

CRIME PREVENTION

6.3 Conditions attached to Licences and Certificates will, so far as possible, reflect local crime prevention strategies. Examples of such conditions can be found in the Pool of Conditions relating to prevention of crime and disorder contained in the Statutory Guidance to the Act.

CULTURAL STRATEGIES

6.4 The Council will make arrangements to monitor the impact of licensing on regulated entertainment, particularly live music, ensuring that only necessary, proportionate and reasonable licensing conditions impose any restrictions on such events.

6.5 Where there is any indication that such events are being deterred by licensing requirements, the statement of licensing policy will be examined to see if the situation might be reversed.

PLANNING AND BUILDING CONTROL

6.8 The Council recognises that there should be a clear separation of the planning, building control and licensing regimes in order to avoid duplication and inefficiency.

6.9 Licensing applications will not be a re-run of the planning application and will not cut across decisions made by the planning committee or permissions granted on appeal.

6.10 The Council will however expect applications for premises licences or for a variation to an existing premises licence at permanent commercial premises to be from businesses having the relevant planning consent for the property concerned. In addition, persons submitting temporary event notices should ensure the premises in question has the requisite planning consent for the

proposed activities and hours of operation. Where this is not the case, applicants will be expected to show good reason why the premises do not have planning permission.

- 6.11 The Croydon Local Plan sets out the criteria that will be used to assess planning applications for any changes of use that require planning permission. Some changes of use do not require planning permission but an application for prior approval may be required to ascertain whether there are matters related to the change of use that do require planning permission. Applicants should contact the Council's Development Management service at development.management@croydon.gov.uk with any enquiries related to planning applications or the prior approval process.
- 6.12 Any application for planning permission will be expected to take into account the impact of noise and fumes (and other forms of potential nuisance) on neighbouring premises and to provide details of any mitigating measures, as applicable.
- 6.13 The Council will ensure that if requested, reports will be sent from the licensing committee to the planning committee advising them of the situation regarding licensed premises in Croydon, including the general impact of alcohol related crime and disorder, to assist them in their decision-making.

ADVANCING EQUALITY

- 6.14 The Council recognises its legal obligation under the Equality Act 2010 to eliminate unlawful discrimination, harassment and victimisation, advance equality of opportunity and foster good relations between people who share a characteristic and those who don't.
- 6.15 The Council will assess and consult on the likely impact and monitor for any adverse impact on the advancement of equality which may arise as a result of this Policy Document and will publish the results.

DUPLICATION

- 6.16 The Council will, so far as possible, avoid duplication with other legislation and regulatory regimes that already place obligations on employees and operators, e.g. the Health and Safety at Work etc. Act 1974, the Environmental Protection Act 1990, the Regulatory Reform Fire Safety Order 2005 and the Equality Act 2010 in respect of accessibility for disabled people.
- 6.17 Conditions relating to public safety will only be attached to premises licences and club premises certificates where considered necessary for the promotion of that licensing objective and not covered by any other legislation and where regulations do not cover the unique circumstances of certain licensable activities in specific premises.
- 6.18 The Council acknowledges that bingo clubs are dealt with under the Gambling Act 2005 and will have due regard to the relevant advice regarding duplicating

licence conditions which has been given under both this legislation and the 2003 Act when dealing with applications relating to alcohol, regulated entertainment or late night refreshment under the 2003 Act.

9. STANDARDISED CONDITIONS

- 9.1 Where Conditions are properly attached to licences or certificates they will be tailored to the individual style and characteristics of the particular premises and events concerned.

10. ENFORCEMENT

- 10.1 It is essential that licensed premises are maintained and operated so as to ensure the continued promotion of the licensing objectives and compliance with the specific requirements of the 2003 Act and it is the responsibility of premises licence holders and designated premises supervisors (where applicable) to ensure this happens and that regulatory compliance is maintained. The Council and its partners will make arrangements to monitor premises and take appropriate enforcement action to ensure this but enforcement action should be considered to be the last resort and such intervention should not be necessary where premises are operated & managed effectively.

- 10.2 Each of the Responsible Authorities under the Act may make representations on an application or seek a review of a premises licence/club premises certificate, based on concerns around any of the licensing objectives. That said, it is anticipated that specific responsible authorities will take a central advisory & enforcement role, as necessary, with regard to relevant licensing objectives, for example –

- Prevention of crime and disorder – Police
- Prevention of Public Nuisance – Council Environmental Health (Pollution) Team and the Planning Department
- Public Safety – Council Food & Safety Team or HSE (as applicable) and the LFB
- Protection of Children from Harm – Croydon Children’s Safeguarding Board, Police and the Trading Standards Team

- 10.3 Under the London Borough of Croydon Licensing Act 2003 Enforcement Protocol, originally approved by the Council’s substantive Licensing Committee on 21 June 2006, using the principles of risk assessment, the Council will work closely with the responsible authorities in enforcing licensing law and inspecting licensed premises. This should ensure that resources are more effectively concentrated on problem and high risk premises. This Protocol shall be reviewed, through a separate process to this policy review in the coming months and an updated version shall be available from the Council Licensing Team and posted on the Council’s website.

10.4 The Council will carry out its regulatory functions in accordance with good enforcement practice and particular regard will be had to fundamental principles. In that regard, Enforcement shall be:

- Targeted
- Consistent
- Transparent
- Proportionate
- Necessary

Any enforcement activity shall be undertaken in a fair, open and consistent manner in conformity with the above principles.

The Home Office has produced Statutory Guidance under Section 182 of the Licensing Act 2003. The following paragraphs from the Guidance are reproduced below to assist the sub committee –

10.8 The licensing authority may not impose any conditions unless its discretion has been engaged following receipt of relevant representations and it is satisfied as a result of a hearing (unless all parties agree a hearing is not necessary) that it is appropriate to impose conditions to promote one or more of the four licensing objectives.

The cumulative impact of a concentration of licensed premises

What is cumulative impact?

14.20 The concept of “Cumulative impact” has been described within this guidance and used by licensing authorities within their statements of licensing policy since the commencement of the 2003 Act. ‘Cumulative impact assessments’ were introduced in the 2003 Act by the Policing and Crime Act 2017, with effect from 6 April 2018. Cumulative impact is the potential impact on the promotion of the licensing objectives of a number of licensed premises concentrated in one area.

14.21 In some areas where the number, type or density of licensed premises, such as those selling alcohol or providing late night refreshment, is high or exceptional, serious problems of nuisance and disorder may arise outside or some distance from those premises. Such problems generally occur as a result of large numbers of drinkers being concentrated in an area, for example when leaving premises at peak times or when queuing at fast food outlets or for public transport.

14.22 Queuing in itself may lead to conflict, disorder and anti-social behaviour. Moreover, large concentrations of people may also attract criminal activities such as drug dealing, pick pocketing and street robbery. Local services such as public transport, public lavatory provision and street cleaning may not be able to meet the demand posed by such concentrations of drinkers leading to issues such as street fouling, littering, traffic and public nuisance caused by concentrations of people who cannot be effectively dispersed quickly.

14.23 Variable licensing hours may facilitate a more gradual dispersal of customers from premises. However, in some cases, the impact on surrounding areas of the behaviour of the customers of all premises taken together will be greater than the

impact of customers of individual premises. These conditions are more likely to arise in town and city centres, but may also arise in other urban centres and the suburbs, for example on smaller high streets with high concentrations of licensed premises.

Cumulative impact assessments

14.24 A cumulative impact assessment (CIA) may be published by a licensing authority to help it to limit the number or types of licence applications granted in areas where there is evidence to show that the number or density of licensed premises in the area is having a cumulative impact and leading to problems which are undermining the licensing objectives. CIAs relate to applications for new premises licences and club premises certificates and applications to vary existing premises licences and club premises certificates in a specified area.

14.25 Section 5A of the 2003 Act sets out what a licensing authority needs to do in order to publish a CIA and review it, including the requirement to consult with the persons listed in section 5(3) of the 2003 Act. The 2003 Act does not stipulate how the CIA should be used once published, because the requirements for determining applications for new licences or variations are the same in areas with a CIA as they are elsewhere, as set out in sections 18, 35, 72 and 85 of the Act. However, any CIA published by a licensing authority must be summarised in its statement of licensing policy. Under section 5(6D) a licensing authority must also have regard to any CIA it has published when determining or revising its statement of licensing policy.

14.26 The CIA must include a statement saying that the licensing authority considers that the number of premises licences and/or club premises certificates in one or more parts of the area described is such that it is likely that granting further licences would be inconsistent with the authority's duty to promote the licensing objectives. As part of the publication a licensing authority must set out the evidential basis for its opinion.

14.27 CIAs may relate to premises licensed to carry on any licensable activity, including the sale of alcohol for consumption on or off the premises, and the provision of late night refreshment. This includes late night refreshment providers which are not licensed to sell alcohol. A CIA may relate to all premises licences and club premises certificates in the area described in the assessment or parts thereof, or only to premises of a particular kind described in the assessment. For example, it may be appropriate for the licensing authority to only include off-licences or nightclubs within the scope of its assessment. The licensing authority must make clear, when publishing its CIA, which premises types it applies to. CIAs do not apply to TENs; however it is open to the police and environmental health authority (as relevant persons) to refer to evidence published within a CIA when objecting to a TEN.

14.28 While the evidence underpinning the publication of a CIA should generally be suitable as the basis for a decision to refuse an application or impose conditions, it does not change the fundamental way that decisions are made under the 2003 Act. Each decision in an area subject to a CIA therefore still needs to be made on a case-by-case basis and with a view to what is appropriate for the promotion of the licensing objectives. Importantly, the publication of a CIA would not remove a licensing authority's discretion to grant applications for new licences or applications

to vary existing licences, where the authority considers this to be appropriate in the light of the individual circumstances of the case.

Evidence of cumulative impact

14.29 As noted above, there must be an evidential basis for the decision to publish a CIA. Local Community Safety Partnerships and responsible authorities, such as the police and the environmental health authority, may hold relevant information which would inform licensing authorities when establishing the evidence base for publishing a CIA. Evidence of cumulative impact on the promotion of the licensing objectives needs to relate to the relevant problems identified in the specific area to be covered by the CIA. Information which licensing authorities may be able to draw on includes:

- local crime and disorder statistics, including statistics on specific types of crime and crime hotspots;
- statistics on local anti-social behaviour offences;
- health-related statistics such as alcohol-related emergency attendances and hospital admissions;
- environmental health complaints, particularly in relation to litter and noise;
- complaints recorded by the local authority, which may include complaints raised by local residents or residents' associations;
- residents' questionnaires;
- evidence from local and parish councillors; and
- evidence obtained through local consultation.

14.30 The licensing authority may consider this evidence, alongside its own evidence of the impact of licensable activities within its area, and consider in particular the times at which licensable activities are carried on. Information which may inform consideration of these issues includes:

- trends in licence applications, particularly trends in applications by types of premises and terminal hours;
- changes in terminal hours of premises;
- premises' capacities at different times of night and the expected concentrations of drinkers who will be expected to be leaving premises at different times.

14.31 Where existing information is insufficient or not readily available, but the licensing authority believes there are problems in its area resulting from the cumulative impact of licensed premises, it can consider conducting or commissioning a specific study to assess the position. This may involve conducting observations of the night-time economy to assess the extent of incidents relating to the promotion of the licensing objectives, such as incidences of criminal activity and anti-social behaviour, examples of public nuisance, specific issues such as underage drinking and the key times and locations at which these problems are occurring.

14.32 In order to identify the areas in which problems are occurring, information about specific incidents can be mapped and, where possible, a time analysis undertaken to identify the key areas and times at which there are specific issues.

14.33 After considering the available evidence and consulting those individuals and organisations listed in section 5(3) of the 2003 Act and any others, a licensing

authority may be satisfied that it is appropriate to publish a CIA. The CIA should also be considered alongside local planning policy and other factors which may assist in mitigating the cumulative impact of licensed premises, as set out in paragraph 14.46.

Effect of cumulative impact assessments

14.39 When publishing a CIA a licensing authority is required to set out evidence of problems that are being caused or exacerbated by the cumulative impact of licensed premises in the area described. The evidence is used to justify the statement in the CIA that it is likely that granting further premises licences and/or club premises certificates in that area (limited to a kind described in the assessment), would be inconsistent with the authority's duty to promote the licensing objectives.

14.40 In publishing a CIA a licensing authority is setting down a strong statement of intent about its approach to considering applications for the grant or variation of premises licences or club premises certificates in the area described. Having published a CIA a licensing authority must have regard to the assessment when determining or revising its statement of licensing policy. It is therefore expected that, in respect of each relevant application in the area concerned, the licensing authority will be considering whether it is appropriate to make a representation to its committee as a responsible authority in its own right. The CIA does not, however, change the fundamental way that licensing decisions are made. It is therefore open to the licensing authority to grant an application where it considers it is appropriate and where the applicant can demonstrate in the operating schedule that they would not be adding to the cumulative impact. Applications in areas covered by a CIA should therefore give consideration to potential cumulative impact issues when setting out the steps that will be taken to promote the licensing objectives. Where relevant representations are received and a licensing authority decides to grant an application it will need to provide the applicant, the chief officer of police and all parties who made relevant representations with reasons for granting the application and this should include any reasons for departing from their own policy.

14.41 The CIA must also stress that it does not relieve responsible authorities (or any other persons) of the need to make relevant representations where they consider it appropriate to do so for the promotion of the licensing objectives. Anyone making a representation may base it on the evidence published in the CIA, or the fact that a CIA has been published. It remains incumbent on all responsible authorities and other persons to ensure that their representations can withstand the scrutiny to which they would be subject at a hearing. As with all licensing applications under the 2003 Act, if there are no representations, the licensing authority must grant the application in terms that are consistent with the operating schedule submitted.

14.42 The absence of a CIA does not prevent any responsible authority or other person making representations on an application for the grant or variation of a licence on the grounds that the premises will give rise to a negative cumulative impact on one or more of the licensing objectives. However, in each case it would be incumbent on the person making the representation to provide relevant evidence of cumulative impact.

14.43 As noted above, CIAs may apply to the impact of a concentration of any licensed premises, including those licensed for the sale of alcohol on or off the premises, and premises licensed to provide late night refreshment. When establishing its evidence base for publishing a CIA, licensing authorities should be considering the contribution to cumulative impact made by different types of premises within its area, in order to determine the appropriateness of including different types of licensed premises within the CIA.

Limitations on special policies relating to cumulative impact

14.44 A CIA should never be absolute. Statements of licensing policy should always allow for the circumstances of each application to be considered properly and for applications that are unlikely to add to the cumulative impact on the licensing objectives to be granted. After receiving relevant representations in relation to a new application for or a variation of a licence or certificate, the licensing authority must consider whether it would be justified in departing from its CIA in the light of the individual circumstances of the case. The impact can be expected to be different for premises with different styles and characteristics. For example, while a large nightclub or high capacity public house might add to problems of cumulative impact, a small restaurant or a theatre may not. If the licensing authority decides that an application should be refused, it will still need to show that the grant of the application would undermine the promotion of one or more of the licensing objectives and that appropriate conditions would be ineffective in preventing the problems involved.

14.45 CIAs should never be used as a ground for revoking an existing licence or certificate when representations are received about problems with those premises. Where the licensing authority has concerns about the effect of activities at existing premises between midnight and 6am on the promotion of the licensing objectives in a specific area, it may introduce an Early Morning Alcohol Restriction Order (EMRO) if there is sufficient evidence to do so (see chapter 17). The “cumulative impact” on the promotion of the licensing objectives of a concentration of licensed premises should only give rise to a relevant representation when an application for the grant or variation of a licence or certificate is being considered.

14.46 CIAs must not impose quotas based on either the number of premises or the capacity of those premises. This is because quotas that indirectly have the effect of predetermining the outcome of any application would have no regard to the individual characteristics of the premises concerned.

- 4.2 All relevant parties have been made aware of the date, time and location of the Sub Committee meeting.
- 4.3 An Ordnance Survey extract map of the area with the application premises shown at the centre is attached at Appendix A3.

* required information

Section 1 of 21

You can save the form at any time and resume it later. You do not need to be logged in when you resume.

System reference

Not Currently In Use

This is the unique reference for this application generated by the system.

Your reference

[Redacted]

You can put what you want here to help you track applications if you make lots of them. It is passed to the authority.

Are you an agent acting on behalf of the applicant?

- Yes
- No

Put "no" if you are applying on your own behalf or on behalf of a business you own or work for.

Applicant Details

* First name

RESHMA

* Family name

TALWAR

* E-mail

[Redacted]

Main telephone number

[Redacted]

Include country code.

Other telephone number

[Redacted]

Indicate here if you would prefer not to be contacted by telephone

Are you:

- Applying as a business or organisation, including as a sole trader
- Applying as an individual

A sole trader is a business owned by one person without any special legal structure. Applying as an individual means you are applying so you can be employed, or for some other personal reason, such as following a hobby.

Continued from previous page...

Your position in the business Home country

The country where the headquarters of your business is located.

Business Address

If you have one, this should be your official address - that is an address required of you by law for receiving communications

Building number or name Street District City or town County or administrative area Postcode Country **Section 2 of 21****PREMISES DETAILS**

I/we, as named in section 1, apply for a premises licence under section 17 of the Licensing Act 2003 for the premises described in section 2 below (the premises) and I/we are making this application to you as the relevant licensing authority in accordance with section 12 of the Licensing Act 2003.

Premises Address

Are you able to provide a postal address, OS map reference or description of the premises?

 Address
 OS map reference
 Description
Postal Address Of PremisesBuilding number or name Street District City or town County or administrative area Postcode Country **Further Details**Telephone number Non-domestic rateable value of premises (£)

Section 3 of 21**APPLICATION DETAILS**

In what capacity are you applying for the premises licence?

- An individual or individuals
- A limited company / limited liability partnership
- A partnership (other than limited liability)
- An unincorporated association
- Other (for example a statutory corporation)
- A recognised club
- A charity
- The proprietor of an educational establishment
- A health service body
- A person who is registered under part 2 of the Care Standards Act 2000 (c14) in respect of an independent hospital in Wales
- A person who is registered under Chapter 2 of Part 1 of the Health and Social Care Act 2008 in respect of the carrying on of a regulated activity (within the meaning of that Part) in an independent hospital in England
- The chief officer of police of a police force in England and Wales

Confirm The Following

- I am carrying on or proposing to carry on a business which involves the use of the premises for licensable activities
- I am making the application pursuant to a statutory function
- I am making the application pursuant to a function discharged by virtue of Her Majesty's prerogative

Section 4 of 21**INDIVIDUAL APPLICANT DETAILS****Applicant Name**

Is the name the same as (or similar to) the details given in section one?

- Yes No

If "Yes" is selected you can re-use the details from section one, or amend them as required. Select "No" to enter a completely new set of details.

First name

RESHMA

Family name

TALWAR

Is the applicant 18 years of age or older?

- Yes No

Continued from previous page...

Current Residential Address

Is the address the same as (or similar to) the address given in section one?

- Yes
- No

If "Yes" is selected you can re-use the details from section one, or amend them as required. Select "No" to enter a completely new set of details.

Building number or name

Street

District

City or town

County or administrative area

Postcode

Country

Applicant Contact Details

Are the contact details the same as (or similar to) those given in section one?

- Yes
- No

If "Yes" is selected you can re-use the details from section one, or amend them as required. Select "No" to enter a completely new set of details.

E-mail

Telephone number

Other telephone number

* Date of birth / /

* Nationality

Documents that demonstrate entitlement to work in the UK

Section 5 of 21

OPERATING SCHEDULE

When do you want the premises licence to start? / /

dd mm yyyy

If you wish the licence to be valid only for a limited period, when do you want it to end / /

dd mm yyyy

Provide a general description of the premises

For example the type of premises, its general situation and layout and any other information which could be relevant to the licensing objectives. Where your application includes off-supplies of alcohol and you intend to provide a place for consumption of these off- supplies you must include a description of where the place will be and its proximity to the premises.

It will be Off License Shop, We will be selling alcohol, cigarettes, grocery, toiletry, beverages, confectionery, vegetables,

Continued from previous page...

frozen food and dairy products.

If 5,000 or more people are expected to attend the premises at any one time, state the number expected to attend

Section 6 of 21

PROVISION OF PLAYS

See guidance on regulated entertainment

Will you be providing plays?

- Yes
- No

Section 7 of 21

PROVISION OF FILMS

See guidance on regulated entertainment

Will you be providing films?

- Yes
- No

Section 8 of 21

PROVISION OF INDOOR SPORTING EVENTS

See guidance on regulated entertainment

Will you be providing indoor sporting events?

- Yes
- No

Section 9 of 21

PROVISION OF BOXING OR WRESTLING ENTERTAINMENTS

See guidance on regulated entertainment

Will you be providing boxing or wrestling entertainments?

- Yes
- No

Section 10 of 21

PROVISION OF LIVE MUSIC

See guidance on regulated entertainment

Will you be providing live music?

- Yes
- No

Section 11 of 21

PROVISION OF RECORDED MUSIC

See guidance on regulated entertainment

Will you be providing recorded music?

- Yes
- No

Section 12 of 21

PROVISION OF PERFORMANCES OF DANCE

Continued from previous page...

See guidance on regulated entertainment

Will you be providing performances of dance?

Yes No

Section 13 of 21

PROVISION OF ANYTHING OF A SIMILAR DESCRIPTION TO LIVE MUSIC, RECORDED MUSIC OR PERFORMANCES OF DANCE

See guidance on regulated entertainment

Will you be providing anything similar to live music, recorded music or performances of dance?

Yes No

Section 14 of 21

LATE NIGHT REFRESHMENT

Will you be providing late night refreshment?

Yes No

Section 15 of 21

SUPPLY OF ALCOHOL

Will you be selling or supplying alcohol?

Yes No

Standard Days And Timings

MONDAY

Start 08:00

End 22:00

Start

End

Give timings in 24 hour clock. (e.g., 16:00) and only give details for the days of the week when you intend the premises to be used for the activity.

TUESDAY

Start 08:00

End 22:00

Start

End

WEDNESDAY

Start 08:00

End 22:00

Start

End

THURSDAY

Start 08:00

End 22:00

Start

End

FRIDAY

Start 08:00

End 22:00

Start

End

Continued from previous page...

SATURDAY

Start	<input type="text" value="08:00"/>	End	<input type="text" value="22:00"/>
Start	<input type="text"/>	End	<input type="text"/>

SUNDAY

Start	<input type="text" value="08:00"/>	End	<input type="text" value="22:00"/>
Start	<input type="text"/>	End	<input type="text"/>

Will the sale of alcohol be for consumption:

- On the premises
 Off the premises
 Both

If the sale of alcohol is for consumption on the premises select on, if the sale of alcohol is for consumption away from the premises select off. If the sale of alcohol is for consumption on the premises and away from the premises select both.

State any seasonal variations

For example (but not exclusively) where the activity will occur on additional days during the summer months.

Non-standard timings. Where the premises will be used for the supply of alcohol at different times from those listed in the column on the left, list below

For example (but not exclusively), where you wish the activity to go on longer on a particular day e.g. Christmas Eve

State the name and details of the individual whom you wish to specify on the licence as premises supervisor

Name

First name

Family name

Date of birth / /

Continued from previous page...

Enter the contact's address

Building number or name

Street

District

City or town

County or administrative area

Postcode

Country

Personal Licence number (if known)

Issuing licensing authority (if known)

PROPOSED DESIGNATED PREMISES SUPERVISOR CONSENT

How will the consent form of the proposed designated premises supervisor be supplied to the authority?

- Electronically, by the proposed designated premises supervisor
- As an attachment to this application

Reference number for consent form (if known)

If the consent form is already submitted, ask the proposed designated premises supervisor for its 'system reference' or 'your reference'.

Section 16 of 21

ADULT ENTERTAINMENT

Highlight any adult entertainment or services, activities, or other entertainment or matters ancillary to the use of the premises that may give rise to concern in respect of children

Give information about anything intended to occur at the premises or ancillary to the use of the premises which may give rise to concern in respect of children, regardless of whether you intend children to have access to the premises, for example (but not exclusively) nudity or semi-nudity, films for restricted age groups etc gambling machines etc.

Section 17 of 21

HOURS PREMISES ARE OPEN TO THE PUBLIC

Standard Days And Timings

MONDAY

Start

End

Start

End

Give timings in 24 hour clock. (e.g., 16:00) and only give details for the days of the week when you intend the premises to be used for the activity.

Continued from previous page...

TUESDAY

Start	<input type="text" value="08:00"/>	End	<input type="text" value="22:00"/>
Start	<input type="text"/>	End	<input type="text"/>

WEDNESDAY

Start	<input type="text" value="08:00"/>	End	<input type="text" value="22:00"/>
Start	<input type="text"/>	End	<input type="text"/>

THURSDAY

Start	<input type="text" value="08:00"/>	End	<input type="text" value="22:00"/>
Start	<input type="text"/>	End	<input type="text"/>

FRIDAY

Start	<input type="text" value="08:00"/>	End	<input type="text" value="22:00"/>
Start	<input type="text"/>	End	<input type="text"/>

SATURDAY

Start	<input type="text" value="08:00"/>	End	<input type="text" value="22:00"/>
Start	<input type="text"/>	End	<input type="text"/>

SUNDAY

Start	<input type="text" value="08:00"/>	End	<input type="text" value="22:00"/>
Start	<input type="text"/>	End	<input type="text"/>

State any seasonal variations

For example (but not exclusively) where the activity will occur on additional days during the summer months.

NA

Non standard timings. Where you intend to use the premises to be open to the members and guests at different times from those listed in the column on the left, list below

For example (but not exclusively), where you wish the activity to go on longer on a particular day e.g. Christmas Eve.

NA

Section 18 of 21

LICENSING OBJECTIVES

Describe the steps you intend to take to promote the four licensing objectives:

a) General – all four licensing objectives (b,c,d,e)

Continued from previous page...

List here steps you will take to promote all four licensing objectives together.

CCTV FOTEAGE, RECORDINGS, SELLING ALCOHAL IN A DESIGANATED AREA ONLY WHICH IS SAFE TO DISPLAY AND NOT REACABLE TO UNDERAGE 18, Alarm system connected to Police, Panic Alarm, Appropriate Signs (No Alcohol Consumption allowed in the premises, Staff only Area), Locked Display Chiller for Alcohol, Appoint appropriate staff for Security on the door, Selling Alcohol only in Permitted hours, appoint trained staff and review training time to time, Stay in touch with local Council and local Police regarding any updates on awareness of Laws and prevention of crime, We will manage Full Risk Assessment for staff or customers according to Health & Safety Measures Law, We will make sure that staff is aware of the risk assessment and precautionary measures, We will keep staff training record for inspection when required, First Aid Kit, Fire Extinguisher, Temperature Control, We will have enough staff all the time to prevent the long queues, Sufficient staff will be available while opening and closing timings to control and manage good order and safety and security, Sharp objectives like Knives, Blades will keep in control area, Challenge 25 sign will be displayed, Staff can ask to children for their Id if they are not sure about their age, The admittance of children can only be permitted if they are accompanied by an adult, Display posters at the premises stating that it is an offence to purchase alcohol on behalf of an underage person,

b) The prevention of crime and disorder

CCTV FOTEAGE, RECORDINGS, Alarm system connected to Police, Panic Alarm, Appropriate Signs (No Alcohol Consumption allowed in the premises, Staff only Area), Locked Display Chiller for Alcohol, Appoint appropriate staff for Security on the door, Selling Alcohol only in Permitted hours, appoint trained staff and review training time to time, Stay in touch with local Council and local Police regarding any updates on awareness of Laws and prevention of crime,

c) Public safety

We will manage Full Risk Assessment for staff or customers according to Health & Safety Measures Law, We will make sure that staff is aware of the risk assessment and precautionary measures, We will keep staff training record for inspection when required, First Aid Kit, Fire Extinguisher, Temperature Control,

d) The prevention of public nuisance

We will have enough staff all the time to prevent the long queues, Sufficient staff will be available while opening and closing timings to control and manage good order and safety and security,

e) The protection of children from harm

SELLING ALCOHAL IN A DESIGANATED AREA ONLY WHICH IS SAFE TO DISPLAY AND NOT REACABLE TO UNDERAGE 18, Sharp objectives like Knives, Blades will keep in control area, Challenge 25 sign will be displayed, Staff can ask to children for their Id if they are not sure about their age. The admittance of children can only be permitted if they are accompanied by an adult, Display posters at the premises stating that it is an offence to purchase alcohol on behalf of an underage person,

Section 19 of 21

NOTES ON DEMONSTRATING ENTITLEMENT TO WORK IN THE UK

SHOP FLOOR 103'4" x 16'8" (31.5m x 5.1m)

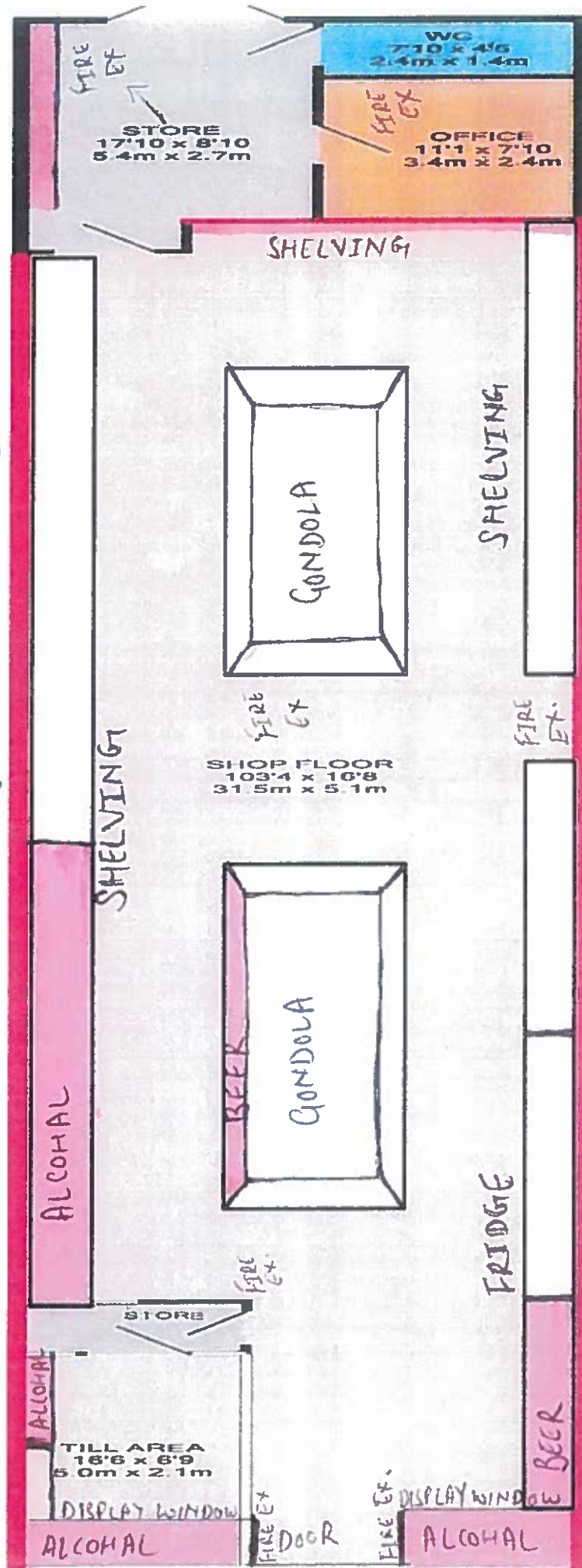

SHOP FLOOR 103'4" x 16'8" (31.5m x 5.1m)

A1

I would like to make representations with regard to application list no 1/17, which relates to the sale of alcohol at The Warehouse, 12 Central Parade, New Addington, CRO0JB.

I am making representation in order to oppose the application to sell alcohol at this premises.

In the Central Parade area of New Addington we have a Cumulative Impact Zone. This was initiated because of the already high concentration of outlets that sell alcohol in this area. Given the CIZ, the presumption should be that the license is not granted.

Central Parade is already the focus of crime and antisocial behaviour in the ward. I believe issues with regard to crime and antisocial behaviour are exacerbated by the number of properties that sell alcohol. Therefore, in order to uphold the licensing objectives of the prevention of crime and disorder, public safety and the prevention of public nuisance, this license should not be granted.

It is widely felt in New Addington that there are already too many shops that are licensed to sell alcohol on Central Parade. Therefore, we should look to ensure that the Parade is a vibrant mix of shops and services. Granting another premises license would not do this and for this reason as well, I think the license should not be granted.

From:
Councillor Oliver Lewis
C/O The Town Hall
Katherine Street
Croydon
CRO 1NX

A2

I Strongly object to The warehouse on 12 Central parade, New Addington selling alcohol based on...

New Addington has high crime related to Alcohol use, and I object on the basis that opening another outlet will add to the problems already in place.

Reason for objection is, I live in the impact zone of the address of applicant.

From:

~~XXXXXXXXXX~~
~~XXXXXXXXXX~~
New Addington
Croydon
~~XXXXXXXXXX~~

Premises: 12 Central Parade, New Addington, Croydon, CR0 0JB

The London Fire Commissioner (the Commissioner) is the fire and rescue authority for London. The Commissioner is responsible for enforcing the Regulatory Reform (Fire Safety) Order 2005 (The Order) in London.

With reference to the application dated 19/04/2018, the application has been examined and the **Commissioner wants to make a representation** to the Licensing Authority in relation to this application.

The applicant has been informed that the Commissioner will be making a representation to the Licensing Authority.

The items that are of concern to the Commissioner are detailed

- Insufficient means of escape from rear of premises
- Excessive travel distance from rear of premises to a place of relative safety
- Large amount of combustible items stored in escape routes and a generally poor standard of housekeeping
- Significant amount of potential ignition sources present
- Unsuitable level of detection and warning

Should these matters be resolved to the satisfaction of this Commissioner at least 2 days prior to the Licensing Committee Hearing the representation will be withdrawn.

An inspecting Officer will not be attending and the Commissioner will rely on written representation alone.

From:

Fire Safety Regulation, South East 1 Team, 169 Union Street, London, SE1 0LL

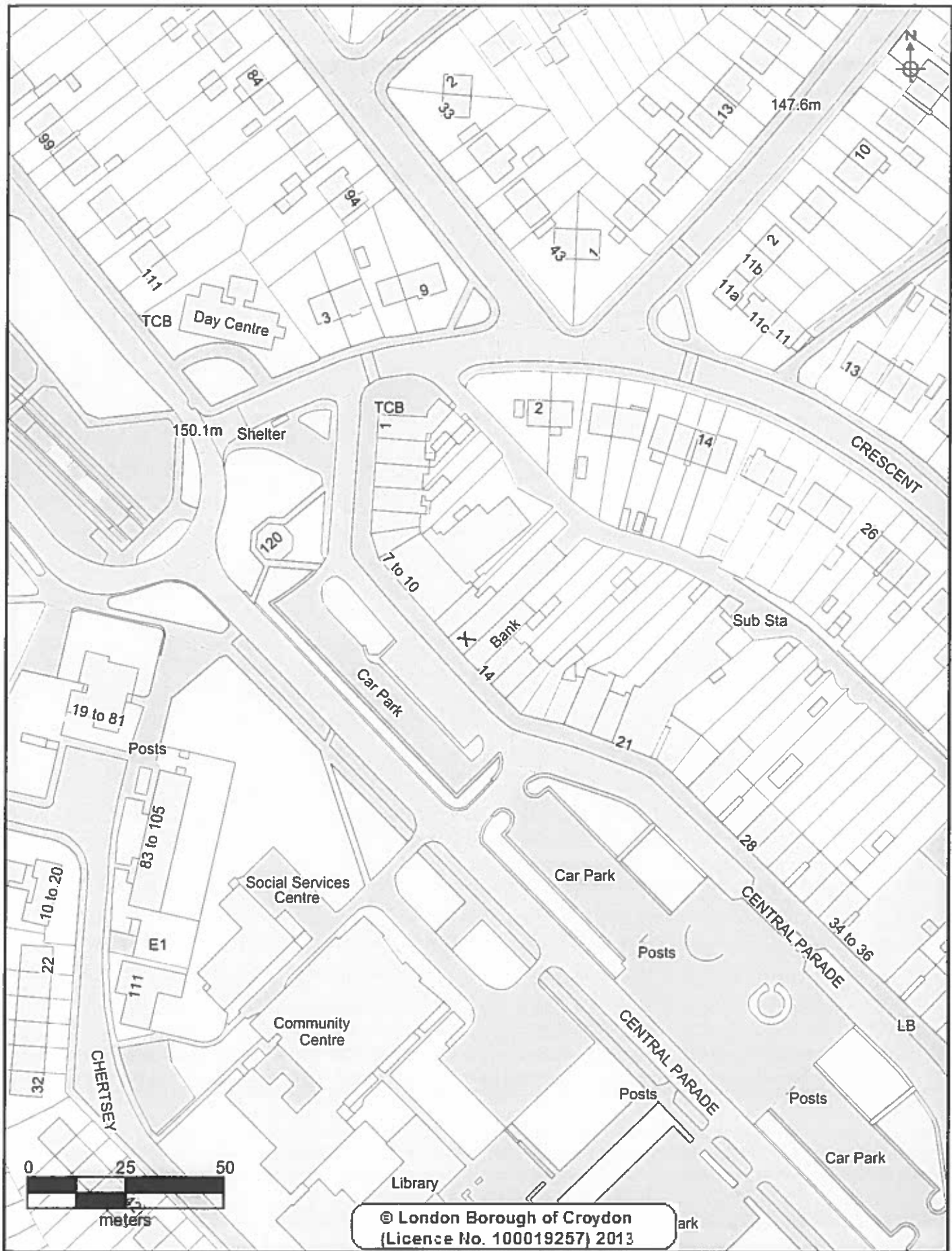

CROYDON
www.croydon.gov.uk

Crown Copyright Ordnance Survey (License No: 100019257) 2011

London Borough Croydon

Scale 1:1250

01-Jun-2018

X Page 42 CENTRAL PARADE



This page is intentionally left blank

RECEIVED 03 MAY 2018

~~XXXXXXXXXX~~
New Addington
Croydon.
~~XXXXXXXXXX~~

27th April 2018

Dear Sir / Madam,

**Re: Alcohol License for The Warehouse, 12 Central Parade
In the name of Reshma Talwar**

I strongly object to this application for the following reasons:

1. There is a CIZ (Cumulative Impact Zone) in place due to the numerous existing alcohol outlets along Central Parade.
2. Most of the existing outlets already sell alcohol from early in the morning (6am) until at least 10pm every evening.
3. I believe this gentleman is linked to another shop keeper who already operates 3 of these such shops along Central Parade.
4. Since the Dispersal Zones have been removed, I believe yet another alcohol outlet will un-necessarily create further anti-social issues and Met Police figures show the rate of ASB is already highest around the Central Parade area now.
5. Residents in their homes above the shops already cope with enough anti-social behaviour including individuals urinating and defecating in the stairwells, another alcohol outlet will more than likely add to their stress.

Thank you for reading my objections and I hope my views are taken into consideration.

Yours faithfully



Agenda Item 6

REPORT TO:	LICENSING SUB COMMITTEE 27 June 2018
AGENDA ITEM:	
SUBJECT:	LICENSING ACT 2003 – APPLICATION FOR VARIATION TO PREMISES LICENCE
LEAD OFFICER:	Executive Director, Place Department
CABINET MEMBER:	Cllr. Hamida Ali, Cabinet Member for Communities Safety & Justice
WARDS:	Selsdon & Addington Village
CORPORATE PRIORITY/POLICY CONTEXT: This report is specific to this application and has no implications on the Council's Corporate Policies.	
FINANCIAL SUMMARY: This application is being processed as part of normal duties carried out by the Department with no additional costs involved.	
FORWARD PLAN KEY DECISION REFERENCE NO.: N/A	

For general release

1. RECOMMENDATIONS

- 1.1 The Sub-Committee is asked to determine whether to grant the application for a variation to a premises licence at Addington SF Connect (formerly BP), 215 Selsdon Park Road, Croydon, CR2 8JH.

2. EXECUTIVE SUMMARY

- 2.1 The purpose of this report is to advise the Sub-Committee that an application has been received for a variation to a premises licence under the Licensing Act 2003 ("the Act"). This application is the subject of a representation, therefore a hearing is required.

3. DETAIL

- 3.1 A Protocol for Licensing Hearings and a Procedure for Licensing Sub-Committee Hearings has previously been agreed by the Licensing Committee (minute A/24/05 refers). The protocol has been subsequently amended by the licensing committee (minutes A/32/06, A/40/07 and A/07/12 refer).
- 3.2 The applicant and the party making representations have been notified of the hearing in accordance with the Licensing Act 2003 (Hearings) Regulations 2005 and Licensing Act 2003 (Hearings) (Amendment) Regulations 2005 “the Regulations”. Information to accompany the notice of hearing was provided to the applicant and the party making representations in accordance with “the Regulations”.
- 3.3 Appendix A to this report provides details of this application.

4. FINANCIAL CONSIDERATIONS

1 Revenue and Capital consequences of report recommendations

There are no direct financial implications associated with this report, subject to the risks at 4.2 & 4.3. This application is being processed as part of normal duties and therefore the work associated with it is contained within the departmental budget.

2 The effect of the decision

The decision of the Sub-Committee may be subject to appeal and/or Judicial Review

3 Risks

An appeal against a decision of the Sub-Committee or a Judicial Review of the application process may present financial risks to the Council with regard to any award of costs against it.

4 Options

The options available are: to grant the application, to vary the application, with or without further conditions, or to refuse the application.

5 Savings/ future efficiencies

None identified.

6 (Approved by: Zulfiqar Darr, Interim Head of Finance, Place & Resources)

5. COMMENTS OF THE SOLICITOR TO THE COUNCIL

- 5.1 The Solicitor to the Council comments that the sub-committee must determine

the application, taking into account relevant representations, the Licensing Act 2003, the regulations made thereunder statutory guidance and the Council's own licensing policy.

5.2 (Approved for and on behalf of Jacqueline Harris-Baker, Director of Law & Monitoring Officer)

6. HUMAN RESOURCES IMPACT

6.1 The Human Resources impact of supporting the Licensing Hearings will be contained within the budgeted establishments of the Democratic and Legal Services and Licensing Teams.

6.2 (Approved by: Adrian Prescod, HR Business Partner, for and on behalf of Director of Human Resources, Chief Executive's Department)

7. EQUALITIES IMPACT

7.1 The arrangements for the Licensing Hearings seek to ensure that all applicants and other interested parties receive a fair hearing and that the process is accessible to all groups within the community.

8. ENVIRONMENTAL AND DESIGN IMPACT

8.1 The effective implementation of the Licensing Act 2003 will contribute to an improved environment for local residents and other stakeholders.

9. LICENSING OBJECTIVES IMPACT

9.1 The licensing objectives contained in the Act are:

- the prevention of crime and disorder
- public safety
- the prevention of public nuisance and
- the protection of children from harm.

9.2 Officers comments and relevant representations on the impact of the application on these objectives appear in Appendix A to the application.

10. HUMAN RIGHTS IMPACT

10.1 The Human Rights 1998 (HRA) requires public bodies to ensure everything they do is compatible with Convention Rights and makes it unlawful for a public authority to act incompatibly with those Rights. **Article 6 (A6)** of the European Convention on Human Rights (ECHR) is the right to a fair trial. The key elements of this include:

- The right to a *fair* hearing;
- The right to a *public* hearing;
- The right to a hearing before an *independent and impartial tribunal*;
- The right to a hearing *within a reasonable time*.

- 10.2 When hearing an application, the proceedings of a non-judicial body such as the Licensing Sub Committee, as opposed to an actual Court, need not meet the full requirements of A6 where there is a right of appeal from the Licensing Sub Committee to a Court that does meet the full A6 standards and can consider all aspects of the case (even if that does not include a full re-hearing of the facts).
- 10.3 So, while it is good practice to make a hearing before the Licensing Sub Committee as A6 compliant as possible, it will not be a breach of the HRA if it is not. Further, the hearing of all applications is subject to the principles of Natural Justice and the requirement for decisions to be 'Wednesbury reasonable'.

11. FREEDOM OF INFORMATION/DATA PROTECTION CONSIDERATIONS

- 11.1 Protocols agreed in relation to Licensing Hearings are within the Council's Constitution and will be accessible as part of the Council's Publication Scheme maintained under the Freedom of Information Act.

CONTACT OFFICER: Michael Goddard, Licensing Manager, Place
Department ext. 61838

BACKGROUND DOCUMENTS: Application Forms
Licensing Hearings and Protocol and Procedure

APPENDIX A

1. The Application

1.1 This report concerns an application by BP Oil UK Ltd. for a variation to the premises licence they hold at 215 Selsdon Park Road, Croydon, CR2 8JH.

1.2 A copy of the current premises licence is attached at Appendix A1.

1.3 The variation application seeks the following licensable activities between the hours shown -

The sale by retail of alcohol -

Monday to Sunday 0000 hours (midnight) until 0000 hours (midnight) – 24 hours.

1.4 The application also seeks the removal of the existing conditions at Annex 2 to the current premises licence and to replace them with the conditions listed at Section 16 of the variation application.

1.5 The relevant pages of the application are attached at Appendix A2

2 Promotion of Licensing Objectives

2.1 The applicant provides details in Section 16 of their application of the additional steps, if any, they think appropriate to meet the four licensing objectives should the application to vary be granted.

3 Relevant representations

3.1 A representation has been received on this application. A copy is attached at Appendix A3.

3.2 The applicant has been provided with a written copy of the representations made.

4 Policy Considerations

4.1 Under the terms of the Act, the Council has published a Statement of Licensing Policy. This is available on the Council website at www.croydon.gov.uk. Hard copies are also available from the Council's Place Department and copies of the policy will also be available at the licensing sub committee hearing. The following paragraphs from the Statement are considered particularly relevant with regard to this application.

4.8 The fundamental principles of the Act and its accompanying guidance are that nothing in this 'Statement of Policy' will:

undermine the rights of any person to apply under the 2003 Act for a variety of permissions and have each application considered on its individual merits, or,

override the right of any person to make representations on any application or seek a review of a licence or certificate where they are permitted to do so under the 2003 Act.

- 4.9 Parties should be aware that, for a representation to be considered relevant, it must be one that is about the likely effect of the grant of a new licence/certificate or variation of an existing licence/certificate on the promotion of the four licensing objectives. Also, if the representation is made by an 'other person', it will not be relevant if the licensing authority considers it to be 'vexatious or frivolous', or in the case of a review, 'repetitious'.
- 4.10 Applicants and those making relevant representations in respect of applications or seeking a review of a licence or a certificate have the right of appeal to the Magistrates' Court against the decisions of the Council.
- 4.11 In considering all licence/certificate applications, the Council will take into account the character of the surrounding area, the impact of the licence/certificate on that area and the nature and character of the operation.
- 4.12 As part of any application for a premises licence/club premises certificate or a variation to an existing licence/certificate, applicants are required to submit an 'Operating Schedule', which must include the steps proposed to promote the Licensing Objectives set out in paragraph 2.2.
- 4.13 Part 5 of this Statement gives guidance to applicants on some of the matters they may wish to consider when preparing their Operating Schedules.
- 4.14 Licensing is about permitting activities but also ensuring the responsible management of licensed premises, qualifying clubs and temporary events within the terms of the 2003 Act, and conditions are likely to be attached to licences, certificates and permissions that will cover matters which are within the control of individual licensees.
- 4.15 However, the Council acknowledges that it can only impose conditions where relevant representations have been received on an application and that such conditions must be considered necessary for the promotion of the licensing objectives. Where no relevant representations have been made, the application will be granted by the licensing authority in terms consistent with the applicants operating schedule.
- 4.16 When considering these conditions, the Council will primarily focus on the direct impact of the activities taking place at licensed premises on members of the public living, working or engaged in normal activity in the area concerned.

NEED

- 4.17 The Council will not take 'need' into account when considering an application, as this concerns 'commercial demand' and is a matter for the planning process and the market.

5. LICENSING OBJECTIVES and OPERATING SCHEDULES

5.1.1 The following sections set out the Council's Policy relating specifically to the four Licensing Objectives:

- the prevention of crime and disorder
- public safety
- the prevention of public nuisance
- the protection of children from harm

5.1.2 In each section the Council defines its intended outcome and lists the factors that may influence achieving that particular objective, but because of the wide variety of premises and activities to which this Policy applies, the lists provided are not exhaustive. Applicants will know their premises best and will be expected to address all aspects relevant to the individual style and characteristics of their premises and events.

5.1.3 Further, each section lists possible control measures to assist applicants, but again these lists are not exhaustive. Also, many of the control measures achieve more than one Objective but have not been listed under each Objective and applicants do not need to mention a control measure more than once in their Operating Schedule.

5.2 Crime and Disorder

5.2.1 Croydon Council is committed to reducing crime and disorder within the Borough and creating an environment where people feel safe.

5.2.2 In addition to the requirements under the 2003 Act for the Council to promote the licensing objective of preventing crime and disorder, it also has a duty under Section 17 of the Crime and Disorder Act 1998 to do all it reasonably can to prevent crime and disorder in the Borough.

5.2.3 Licensed premises, especially those offering late night/early morning entertainment, alcohol and/or refreshment, can be a source of crime and disorder problems.

5.2.4 The Council considers that the promotion of the Licensing Objective to prevent crime and disorder also places a responsibility on licence holders to work in partnership to achieve this Objective.

5.2.5 The Council will expect applicants to demonstrate in their Operating Schedule that suitable and sufficient measures have been identified and will be implemented and maintained so as to minimise or prevent crime and disorder in and around the vicinity of their premises and events.

5.2.6 The Licensing Authority recommends that for certain events, a comprehensive risk assessment is undertaken by premises licence

applicants & holders to ensure that crime and disorder and public safety matters are identified and addressed. For larger public events, including those in open spaces and for premises that wish to stage promotions or events, the Licensing Authority recommends that licence applicants and holders address Risk Assessment and post event debrief processes in their application operating schedule/event planning.

5.2.7 Applicants and premises licence holders may wish to engage the services of suitably trained individuals or companies to assist them in this risk assessment process. In addition, they may seek guidance and advice from the Licensing Authority or the Metropolitan Police regarding the process, although the responsibility for undertaking the risk assessment remains with the Applicant/Premises License holder as neither body is able to actually undertake such risk assessments for applicants/licence holders. Applicants and premises licence holders are also reminded that the Licensing Authority is not able to recommend the services of a particular individual or company for this purpose.

5.2.8 Drugs, violence, anti social behaviour and theft of customers property are examples of crime and disorder issues which may be addressed by the following examples of recommended management practice being included in operating schedules, having due regard to the type of premises and/or activities:

- effective and responsible management and supervision of the premises, including associated open areas, appropriate storage of alcohol, discouraging loitering/consuming alcohol outside the premises, ensuring opening hours are adhered to
- participation in responsible management schemes such as the 'Best Bar None' accreditation/award scheme
- appropriate instruction, training and supervision of those employed or engaged to prevent incidents of crime and disorder
- adoption of existing and future best practice guidance (e.g. Safer Clubbing, the National Alcohol Harm Reduction Toolkit and other recognised codes of practice including those relating to drinks' promotions, i.e. The Point of Sale Promotions published by the British Beer and Pub Association and cheap drinks deals/Happy Hours)
- acceptance of accredited 'proof of age' documentation, as recognised by the Council in consultation with the Police
- maintaining appropriate signage and a refusals log
- employment of sufficient SIA licensed door staff, i.e. within nationally accepted standards
- provision of toughened or plastic glasses

- provision of secure deposit boxes for confiscated items as recognised by the Council in conjunction with the Police
- provision of litter bins and security measures, such as lighting outside premises
- Other schemes including only purchasing alcohol from authorised wholesalers, not selling certain alcohol types/strengths (e.g. high strength beers/ciders or single cans above 6% ABV), restricting sales on certain alcohol types (e.g. miniature spirits), allowing a 'track and trace' identifier on products so Police/Trading Standards can identify which off-licence seized alcohol is from, signing up to local responsible retailer schemes
- Provision of closed circuit television, with cameras covering relevant internal and external areas (including beer gardens) and entrances/exits to premises

Note: As this Policy applies to a wide range of premises and activities, the above list will not be applicable in all cases and in some cases additional matters may need addressing.

5.2.9 Additionally, when preparing their Operating Schedules, applicants are recommended to seek advice from the Council Licensing Team and Croydon Police Licensing and/or Crime Prevention Officers, as well as taking into account, as appropriate, local planning and transport policies, and, tourism, cultural and crime prevention strategies.

5.2.10 Where relevant representations have been made, the Council will consider attaching conditions to licences and permissions to deter and prevent crime and disorder both inside and immediately outside the premises.

5.3 Public Safety

5.3.1 The Council is committed to ensuring that the safety of any person visiting or working in licensed premises is not compromised. To this end, applicants will be expected to demonstrate in their Operating Schedule that suitable and sufficient measures have been identified and will be implemented and maintained to ensure public safety, relevant to the individual style and characteristics of their premises and events.

5.3.2 The 2003 Act covers a wide range of premises that require licensing, including, cinemas, concert halls, theatres, nightclubs, public houses, off licences, cafés/restaurants, fast food outlets/takeaways and sometimes open spaces.

5.3.3 Each of these types of premises present a mixture of different risks, with many common to most premises and others unique to specific operations. These will range from fire safety, including fire precautions and means of escape arrangements in all types of premises, to the use of scenery and pyrotechnics in theatres and special lighting effects in night clubs.

5.3.4 It is essential that premises are constructed or adapted and operated so as to acknowledge and safeguard occupants against these risks.

5.3.5 The following examples of influencing factors are given to assist applicants when addressing the issue of public safety during the preparation of their Operating Schedule:

- the number of people attending the premises
- the condition, design and layout of the premises, including the means of escape in case of fire
- the nature of the activities to be provided, in particular the sale of alcohol and including whether those activities are of a temporary or permanent nature
- the hours of operation and hours of opening if different
- customer profile (i.e. age, mobility)
- the use of special effects such as strobe lighting, lasers, pyrotechnics, smoke machines, foam machines etc.

5.3.6 Public safety issues may be addressed by the following examples of recommended management practice being included in operating schedules, having due regard to the type of premises and/or activities:

- effective and responsible management of premises
- provision of a sufficient number of people employed or engaged to secure the safety of everyone attending the premises or event, i.e. number of door supervisors within nationally accepted standards (and having SIA accreditation where necessary)
- appropriate instruction, training and supervision of those employed or engaged to secure the safety of everyone attending the premises or event
- suitable customer-care policies for assisting lone customers taken ill or injured etc. at the premises
- provision of effective CCTV in and around premises
- provision of toughened or plastic glasses
- implementation of crowd management measures
- regular testing (and certification where appropriate) of procedures, appliances, systems etc. pertinent to safety codes and standards

Note: As this Policy applies to a wide range of premises and activities, the above list will not be applicable in all cases and in some cases additional matters may need addressing.

5.3.8 Additionally, when preparing their Operating Schedules, applicants are recommended to seek advice from the Council's Health and Safety Officers and the London Fire Brigade.

5.3.9 The Council will consider attaching Conditions to licences and permissions to promote public safety.

5.4 Prevention of Public Nuisance

- 5.4.1 The Council recognises the need to protect the amenities of people living, visiting and working in the vicinity of licensed premises, whilst balancing the rights of businesses to develop.
- 5.4.2 Licensed premises, especially those operating late at night and in the early hours of the morning, can give rise to a range of public nuisances which may impact adversely on local communities.
- 5.4.3 These concerns mainly relate to noise and disturbance, light pollution, noxious smells, litter and anti-social behaviour and due regard will be taken on the impact these may have.

LICENSING HOURS

- 5.4.4 The Council will generally deal with the issue of licensing hours having due regard to the individual merits of each application, considering the potential for nuisance associated with the style, characteristics and activities of the business and examining any steps that might reduce the risk of nuisance.
- 5.4.5 The Council recognises that longer licensing hours for the sale of alcohol will avoid concentrations of people leaving premises at the same time, which is necessary to reduce the potential for friction at late night fast food outlets, taxi ranks/minicab offices and other sources of transport that can lead to disorder and disturbance.
- 5.4.6 The Council will not set fixed trading hours within designated areas (“zoning”) as it recognises this could lead to significant movements of people across boundaries at particular times seeking premises opening later and would lead to the peaks of disorder and disturbance the Council is trying to avoid. Additionally, this would seemingly treat residents in one area less favourably than those in another.
- 5.4.7 However, although the Council will treat each case on its individual merits, generally it will not grant permission for licensable activities beyond 2330 hours on Sundays to Thursdays and Midnight on Fridays and Saturdays in respect of public houses situated in areas having denser residential accommodation. The Council would expect good reasons to be given to support any application for extensions beyond these hours, including addressing possible disturbance to residents and local parking. Additionally, in these areas, consideration will be given to imposing stricter conditions in respect of noise control.

SHOPS, STORES AND SUPERMARKETS

- 5.4.8 The Council acknowledges that the Guidance issued under section 182 of the Licensing Act 2003 states that shops, stores and supermarkets should normally be free to provide sales of alcohol for consumption off the premises

at any times when the retail outlet is open for shopping unless there are good reasons, based on the licensing objectives, for restricting those hours.

- 5.4.9 However, there is local concern about crime and disorder associated with shops licensed to sell alcohol off the premises. Accordingly, while the Council will treat each case on its individual merits there will be a presumption that permitted hours for the sale of alcohol will be restricted to between 8am and 11.30pm on Sunday to Thursday and 8am to midnight on Friday and Saturday in respect of shops in residential areas or within one of the four relevant Cumulative Impact Zones where representations are made by the police and/or local residents and where premises are shown to be a focus of crime, disorder or nuisance. Applications to vary the permitted hours for the sale of alcohol off the premises within the above hours shall similarly be treated on their merits

PREVENTION OF PUBLIC NUISANCE - GENERALLY

- 5.4.10 The Council will expect applicants to demonstrate in their Operating Schedule that they have identified satisfactory measures and will implement and maintain these so as to prevent public nuisance, having due regard to the style, characteristics and activities of their particular premises and events and of the locality.

- 5.4.11 The following examples of influencing factors are given to assist applicants when addressing the issue of the prevention of public nuisance during the preparation of their Operating Schedule:

- the location of the premises and proximity to residential or other noise sensitive premises
- effective and responsible management and supervision of the premises and associated open areas
- the hours of opening
- the nature of the activities to be provided and their location within the premises, the customer profile, whether the activities are temporary or permanent and whether they are to be held inside or outside
- the design and layout of the premises and in particular the presence of noise limiting features
- the number of people attending the premises
- the availability of public transport
- a 'wind down' period between the end of the licensable activities and the closure of the premises
- a 'last admission time' policy

- 5.4.12 Public nuisance issues may be addressed by the following examples of recommended management practice being included in operating schedules, having due regard to the type of premises and/or activities:

- effective and responsible management and supervision of the premises, including any outside areas

- appropriate instruction, training and supervision of staff to prevent public nuisance
- adoption of current best practice guidance (i.e. Good Practice Guide on the Control of Noise from Pubs and Clubs produced by the Institute of Acoustics), including designing shop fronts so as to limit noise nuisance from premises, i.e. from opening windows or continental-style concertina doors
- control of opening hours for all or part (i.e. garden areas) of the premises – including other times when deliveries take place/rubbish and bottles are binned – and the operation of generating plant and equipment
- installation of acoustic insulation, suitably controlled, sited and silenced ventilation or air conditioning systems and sound insulation and limiting devices
- managing people, including staff and traffic, arriving and leaving the premises, including patrolling entrance queues
- managing the departure of customers
- liaising with transport providers
- siting and operation of necessary external lighting, including security lighting, with the possible nuisance to nearby properties
- suitable arrangements for collection and disposal of litter, including bottles, so as to minimise disturbance to nearby properties
- no flyposting of events/careful distribution of flyers, including by promoters
- effective ventilation systems to prevent nuisance from odour

Note: As this Policy applies to a wide range of premises and activities, the above list will not be applicable in all cases, and in some cases additional matters may need addressing.

5.4.13 Additionally, when preparing their Operating Schedules applicants are recommended to seek advice from Council Pollution Enforcement Officers.

5.4.14 The Council will consider attaching Conditions to licences and permissions to prevent public nuisance.

5.5 Protection of Children from Harm

ACCESS TO LICENSED PREMISES

5.5.1 The wide range of premises that require licensing means that children can be expected to visit many of these, often on their own, to buy food and/or for entertainment.

5.5.2 Although the 2003 Act details certain age and/or time limitations on the admission of accompanied or unaccompanied children to certain types of licensed premises, the Council recognises that additional limitations may have to be considered where it appears necessary to protect them from physical, moral or psychological harm.

5.5.3 The Council will consider the merits of each application before deciding whether to impose conditions limiting the access of children to individual premises.

5.5.4 While no policy can anticipate every situation, the following are examples of premises that will raise concern:

- where entertainment or services of an adult or sexual nature is commonly provided;
- where there have been convictions of members of the current staff at the premises for serving alcohol to minors or with a reputation for underage drinking;
- with a known association with drug taking or dealing;
- where there is a strong element of gambling on the premises (but not, for example, the simple presence of a small number of cash prize gaming machines); and
- where the supply of alcohol for consumption on the premises is the exclusive or primary purpose of the services provided at the premises.

5.5.5 When dealing with a licence application where limiting the access of children is considered necessary, the Council may consider any of the following options, in combination where appropriate:

- limitations on the hours when children may be present;
- limitations on the exclusion of the presence of children under certain ages when particular specified activities are taking place;
- limitations on the parts of premises to which children might be given access;
- age limitations (below 18);
- requirements for an accompanying adult (including for example, a combination of requirements which provide that children under a particular age must be accompanied by an adult); and
- full exclusion of people under 18 from the premises when any licensable activities are taking place.

5.5.6 The Council will not impose conditions on licences or certificates requiring that children be admitted to any premises and, where no limitation is imposed, this will be left to the discretion of the individual licensee. However, where applicants volunteer prohibitions and limitations in their operating schedules and no relevant representations have been made to the Council, these will become conditions attached to the licence/certificate conditions and will be enforceable as such.

RESPONSIBLE AUTHORITY

5.5.8 The Council recognises the Croydon Children's Safeguarding Board and any successor groups to be the 'responsible authority' competent to advise on matters relating to the 'protection of children from harm', and to whom copies of applications should be sent.

CHILDREN IN LICENSED PREMISES – GENERALLY

5.5.13 The Council will expect applicants to demonstrate in their Operating Schedule that suitable and sufficient measures have been identified and will be implemented and maintained to protect children from harm, having due regard to the style, characteristics and activities of their particular premises and/or events.

5.5.14 Whilst children may be adequately protected from harm by the action taken to protect adults, they may also need special consideration and no policy can anticipate every situation. Applicants should consider the following influencing factors, for which there is the potential for children to be exposed, when addressing the issue of protecting children from harm during the preparation of their Operating Schedule:

- drugs, drug taking or drug dealing
- gambling
- activities of an adult or sexual nature
- incidents of violence or disorder
- environmental pollution such as noise or smoke
- special hazards such as falls from heights
- opportunities to purchase, acquire or consume alcohol

Note: A number of these factors are listed in more details in paragraph 5.5.6, but as this Policy applies to a wide range of premises and activities, the above list will not be applicable in all cases, and in some cases additional matters may need addressing.

5.5.15 Protection of children from harm issues may be addressed by the following examples of recommended management practice being included in operating schedules, having due regard to the type of premises and/or activities:

- effective and responsible management of premises
- provision of a sufficient number of people employed or engaged to secure the protection of children, including child performers, from harm
- appropriate instruction, training and supervision of those employed or engaged to secure the protection of children from harm
- adoption of best practice guidance (Public Places Charter)
- limitations on the hours when children may be present in all or parts of the premises
- limitations or exclusions by age when certain activities are taking place
- imposition of requirement for children to be accompanied by an adult
- appropriate instruction and training for counter staff in the prevention of underage sales, including acceptance of accredited 'proof of age' identification, such as a photo card driving licence, a passport, a

citizens card, a validate card or a scheme which carries the PASS hologram logo and keeping a 'refusal' book.

- 5.5.16 Additionally, when preparing their Operating Schedules, applicants are recommended to seek advice from Council Licensing and Child Protection Officers.
- 5.5.17 The Council will consider attaching Conditions to licences and certificates to protect children from harm.
- 5.5.18 While the Council expects Licence holders to comply with the law, the 2003 Act details a number of specific offences designed to protect children in licensed premises and the Council will work closely with the police to ensure the appropriate enforcement of the law, especially relating to the underage sale and supply of alcohol to children.

6. INTEGRATING STRATEGIES and AVOIDING DUPLICATION

- 6.1 There are many stakeholders in the leisure industry covering a wide range of disciplines and although their strategies are not always directly related to the promotion of the licensing objectives, they often indirectly impact upon them.
- 6.2 The Council therefore acknowledges the importance of co-ordinating and integrating these policies, strategies and initiatives and will maintain multi-disciplinary working groups to ensure its licensing policy integrates with local crime prevention, planning, transport, tourism, race equality schemes and cultural strategies, as well as any other plans relating to the management of the town centre and the night-time economy.

CRIME PREVENTION

- 6.3 Conditions attached to Licences and Certificates will, so far as possible, reflect local crime prevention strategies. Examples of such conditions can be found in the Pool of Conditions relating to prevention of crime and disorder contained in the Statutory Guidance to the Act.

CULTURAL STRATEGIES

- 6.4 The Council will make arrangements to monitor the impact of licensing on regulated entertainment, particularly live music, ensuring that only necessary, proportionate and reasonable licensing conditions impose any restrictions on such events.
- 6.5 Where there is any indication that such events are being deterred by licensing requirements, the statement of licensing policy will be examined to see if the situation might be reversed.

PLANNING AND BUILDING CONTROL

- 6.8 The Council recognises that there should be a clear separation of the planning, building control and licensing regimes in order to avoid duplication and inefficiency.
- 6.9 Licensing applications will not be a re-run of the planning application and will not cut across decisions made by the planning committee or permissions granted on appeal.
- 6.10 The Council will however expect applications for premises licences or for a variation to an existing premises licence at permanent commercial premises to be from businesses having the relevant planning consent for the property concerned. In addition, persons submitting temporary event notices should ensure the premises in question has the requisite planning consent for the proposed activities and hours of operation. Where this is not the case, applicants will be expected to show good reason why the premises do not have planning permission.
- 6.11 The Croydon Local Plan sets out the criteria that will be used to assess planning applications for any changes of use that require planning permission. Some changes of use do not require planning permission but an application for prior approval may be required to ascertain whether there are matters related to the change of use that do require planning permission. Applicants should contact the Council's Development Management service at development.management@croydon.gov.uk with any enquiries related to planning applications or the prior approval process.
- 6.12 Any application for planning permission will be expected to take into account the impact of noise and fumes (and other forms of potential nuisance) on neighbouring premises and to provide details of any mitigating measures, as applicable.
- 6.13 The Council will ensure that if requested, reports will be sent from the licensing committee to the planning committee advising them of the situation regarding licensed premises in Croydon, including the general impact of alcohol related crime and disorder, to assist them in their decision-making.

ADVANCING EQUALITY

- 6.14 The Council recognises its legal obligation under the Equality Act 2010 to eliminate unlawful discrimination, harassment and victimisation, advance equality of opportunity and foster good relations between people who share a characteristic and those who don't.
- 6.15 The Council will assess and consult on the likely impact and monitor for any adverse impact on the advancement of equality which may arise as a result of this Policy Document and will publish the results.

DUPLICATION

- 6.16 The Council will, so far as possible, avoid duplication with other legislation and regulatory regimes that already place obligations on employees and operators, e.g. the Health and Safety at Work etc. Act 1974, the Environmental Protection Act 1990, the Regulatory Reform Fire Safety Order 2005 and the Equality Act 2010 in respect of accessibility for disabled people.
- 6.17 Conditions relating to public safety will only be attached to premises licences and club premises certificates where considered necessary for the promotion of that licensing objective and not covered by any other legislation and where regulations do not cover the unique circumstances of certain licensable activities in specific premises.
- 6.18 The Council acknowledges that bingo clubs are dealt with under the Gambling Act 2005 and will have due regard to the relevant advice regarding duplicating licence conditions which has been given under both this legislation and the 2003 Act when dealing with applications relating to alcohol, regulated entertainment or late night refreshment under the 2003 Act.

9. STANDARDISED CONDITIONS

- 9.1 Where Conditions are properly attached to licences or certificates they will be tailored to the individual style and characteristics of the particular premises and events concerned.

10. ENFORCEMENT

- 10.1 It is essential that licensed premises are maintained and operated so as to ensure the continued promotion of the licensing objectives and compliance with the specific requirements of the 2003 Act and it is the responsibility of premises licence holders and designated premises supervisors (where applicable) to ensure this happens and that regulatory compliance is maintained. The Council and its partners will make arrangements to monitor premises and take appropriate enforcement action to ensure this but enforcement action should be considered to be the last resort and such intervention should not be necessary where premises are operated & managed effectively.
- 10.2 Each of the Responsible Authorities under the Act may make representations on an application or seek a review of a premises licence/club premises certificate, based on concerns around any of the licensing objectives. That said, it is anticipated that specific responsible authorities will take a central advisory & enforcement role, as necessary, with regard to relevant licensing objectives, for example –
- Prevention of crime and disorder – Police
 - Prevention of Public Nuisance – Council Environmental Health

- (Pollution) Team and the Planning Department
- Public Safety – Council Food & Safety Team or HSE (as applicable) and the LFB
- Protection of Children from Harm – Croydon Children’s Safeguarding Board, Police and the Trading Standards Team

10.3 Under the London Borough of Croydon Licensing Act 2003 Enforcement Protocol, originally approved by the Council’s substantive Licensing Committee on 21 June 2006, using the principles of risk assessment, the Council will work closely with the responsible authorities in enforcing licensing law and inspecting licensed premises. This should ensure that resources are more effectively concentrated on problem and high risk premises. This Protocol shall be reviewed, through a separate process to this policy review in the coming months and an updated version shall be available from the Council Licensing Team and posted on the Council’s website.

10.4 The Council will carry out its regulatory functions in accordance with good enforcement practice and particular regard will be had to fundamental principles. In that regard, Enforcement shall be:

- Targeted
- Consistent
- Transparent
- Proportionate
- Necessary

Any enforcement activity shall be undertaken in a fair, open and consistent manner in conformity with the above principles.

The Home Office has produced Statutory Guidance under Section 182 of the Licensing Act 2003. The following paragraph from the Guidance is re produced below to assist the sub committee –

10.8 The licensing authority may not impose any conditions unless its discretion has been engaged following receipt of relevant representations and it is satisfied as a result of a hearing (unless all parties agree a hearing is not necessary) that it is appropriate to impose conditions to promote one or more of the four licensing objectives.

4.2 All relevant parties have been made aware of the date, time and location of the Sub Committee meeting.

4.3 An Ordnance Survey extract map of the area with the application premises shown at the centre is attached at Appendix A4.

PREMISES LICENCE

Premises licence number

05/01240/LIPREM

Part 1 – Premises details

Postal address of premises, or if none, ordnance survey map reference or description including Post Town and Post Code

BP Convenience Store
215 Selsdon Park Road
Croydon
CR2 8JH

Telephone number

Where the licence is time limited the dates

N/A

Licensable activities authorised by the licence

The sale by retail of alcohol - Off the premises.

The provision of late night refreshment – On and Off the premises

The times the licence authorises the carrying out of licensable activities

The sale by retail of alcohol – Off the premises
Mondays to Sundays 0800 hours to 2300 hours.

The provision of late night refreshment – On and Off the premises
Mondays to Sundays 2300 hours to 0500 hours

The opening hours of the premises

Subject to any other statutory or planning restrictions, the premises may open at all times for non licensable activities. The hours of opening for licensable activities shall be restricted to those shown above.

Where the licence authorises supplies of alcohol whether these are on and/or off supplies

Off

Part 2

Name, (registered) address, telephone number and e-mail (where relevant) of holder of premises licence

BP Oil UK Limited
Witan Gate House
500/600 Witan Gate
Milton Keynes
Buckinghamshire
MK9 1ES

01908 853 000

Registered number of holder, for example company number, charity number (where applicable)

00446915

Name, address and telephone number of designated premises supervisor where the premises licence authorises the supply of alcohol

Ali Beyzade

~~XXXXXXXXXXXXXXXXXXXX~~
~~XXXXXXXXXXXX~~
~~XXXX~~
~~XXXXXXXXXXXX~~

Personal licence number and issuing authority of personal licence held by designated premises supervisor where the premises licence authorises the supply of alcohol

Personal licence No.: 13/00779/BEXLEY/LI
Licensing Authority: London Borough of Bexley

Date Original Licence granted: 05.09.2005

Date this licence valid from: 05.02.2018

Licensing Manager
Place Department

Annex 1 - Mandatory conditions

The licence is granted subject to the Mandatory conditions for sale of alcohol as set out in the Licensing Act 2003 as amended by the Licensing Act 2003 (Mandatory Licensing *Conditions*) Order 2010 and Order 2014.

1. No supply of alcohol may be made under the Premises Licence –
 - (a) At a time when there is no Designated Premises Supervisor in respect of the Premises Licence; or
 - (b) At a time when the Designated Premises Supervisor does not hold a Personal Licence or his Personal Licence is suspended.
2. Every supply of alcohol under the Premises Licence must be made, or authorised by a person who holds a Personal Licence.
3.
 - (1) The premises licence holder or club premises certificate holder must ensure that an age verification policy is adopted in respect of the premises in relation to the sale or supply of alcohol.
 - (2) The designated premises supervisor in relation to the premises licences must ensure that the supply of alcohol at the premises is carried on in accordance with the age verification policy.
 - (3) The policy must require individuals who appear to the responsible person to be under 18 years of age (or such older age as may be specified in the policy) to produce on request, before being served alcohol, identification bearing their photograph, date of birth and either:-
 - (a) a holographic mark or
 - (b) an ultraviolet feature.

*Responsible person is defined in the Licensing Act 2003 as 'the holder of a premises licence, designated premises supervisor, a person aged 18 or over who is authorised to allow the sale or supply of alcohol by an under 18 or a member or officer of a club present on the club premises who can oversee the supply of alcohol'.

4.
 - (1) A relevant person shall ensure that no alcohol is sold or supplied for consumption on or off the premises for a price which is less than the permitted price.
 - (2) For the purposes of the condition set out in the paragraph (1) above
 - (a) "duty" is to be construed in accordance with the Alcoholic Liquor Duties Act 1979
 - (b) "permitted price" is the price found by applying the formula –

$$P = D + (D \times V)$$

Where

- (i) P is the permitted price
- (ii) D is the amount of duty chargeable in relation to the alcohol as if the duty were charged on the date of the sale or supply of the alcohol, and

- (iii) V is the rate of value added tax chargeable in relation to the alcohol as if the value added tax were charged on the date of the sale or supply of the alcohol;
 - (c) "relevant person" means, in relation to premises in respect of which there is in force a premises licence –
 - (i) The holder of the premises licence
 - (ii) The designated premises supervisor (if any) in respect of such a licence, or
 - (iii) The personal licence holder who makes or authorises a supply of alcohol under such a licence;
 - (d) "relevant person" means, in relation to premises in respect of which there is in force a club premises certificate, any member or officer of the club present on the premises in a capacity which enables the member or officer to prevent the supply in question; and
 - (e) "value added tax" means value added tax charged in accordance with the Value Added Tax Act 1994.
- (3) Where the permitted price given by Paragraph (b) of paragraph (2) would (apart from the paragraph) not be a whole number of pennies, the price given by that sub-paragraph shall be taken to be the price actually given by that sub-paragraph rounded up to the nearest penny.
- (4) Sub-paragraph (2) applies where the permitted price given by Paragraph (b) of paragraph (2) on a day ("the first day") would be different from the permitted price on the next day ("the second day") as a result of a change to the rate of duty or value added tax.
- (5) The permitted price which would apply on the first day applies to sales or supplies of alcohol which take place before the expiry of the period of 14 days beginning on the second day.

Annex 2 - Conditions consistent with the Operating Schedule

1. Alcohol shall not be sold or supplied except during permitted hours. In this condition, permitted hours means:

a. Mondays to Sundays, 0800 hours to 2300 hours

The above restrictions do not prohibit:

(a) during the first twenty minutes after the above hours, the taking of the alcohol from the premises, unless the alcohol is supplied or taken in an open vessel;

(b) the ordering of alcohol to be consumed off the premises, or the despatch by the vendor of the alcohol so ordered;

(c) the sale of alcohol to a trader or club for the purposes of the trade or club;

(d) the sale or supply of alcohol to any canteen or mess, being a canteen in which the sale or supply of alcohol is carried out under the authority of the Secretary of State or an authorised mess of members of Her Majesty's naval, military or air forces;

2. Alcohol shall not be sold in an open container or be consumed in the licensed premises.

Annex 3 - Conditions attached after a hearing by the licensing authority
N/A

Annex 4 – Plans
Attached

* required information

Section 1 of 18

You can save the form at any time and resume it later. You do not need to be logged in when you resume.

System reference This is the unique reference for this application generated by the system.

Your reference You can put what you want here to help you track applications if you make lots of them. It is passed to the authority.

Are you an agent acting on behalf of the applicant?

Yes No

Put "no" if you are applying on your own behalf or on behalf of a business you own or work for.

Applicant Details

* First name

* Family name

* E-mail

Main telephone number Include country code.

Other telephone number

Indicate here if the applicant would prefer not to be contacted by telephone

Is the applicant:

Applying as a business or organisation, including as a sole trader

Applying as an individual

A sole trader is a business owned by one person without any special legal structure. Applying as an individual means the applicant is applying so the applicant can be employed, or for some other personal reason, such as following a hobby.

Applicant Business

Is the applicant's business registered in the UK with Companies House? Yes No

Note: completing the Applicant Business section is optional in this form.

Registration number

Business name If the applicant's business is registered, use its registered name.

VAT number Put "none" if the applicant is not registered for VAT.

Legal status

Continued from previous page...

Applicant's position in the business LICENSING DEPARTMENT

Home country United Kingdom

The country where the applicant's headquarters are.

Registered Address

Address registered with Companies House.

Building number or name WITAN GATE HOUSE

Street 500/600 WITAN GATE

District

City or town MILTON KEYNES

County or administrative area

Postcode MK9 1ES

Country United Kingdom

Agent Details

* First name WINCKWORTH SHERWOOD LLP

* Family name WINCKWORTH SHERWOOD LLP

* E-mail efinlay@wslaw.co.uk

Main telephone number

Include country code.

Other telephone number

Indicate here if you would prefer not to be contacted by telephone

Are you:

An agent that is a business or organisation, including a sole trader

A sole trader is a business owned by one person without any special legal structure.

A private individual acting as an agent

Agent Business

Is your business registered in the UK with Companies House? Yes No

Note: completing the Applicant Business section is optional in this form.

Registration number OC 334359

Business name WINCKWORTH SHERWOOD LLP

If your business is registered, use its registered name.

VAT number GB 183868066

Put "none" if you are not registered for VAT.

Legal status Partnership

Continued from previous page...

Your position in the business Home country

The country where the headquarters of your business is located.

Agent Registered Address

Address registered with Companies House.

Building number or name Street District City or town County or administrative area Postcode Country **Section 2 of 18****APPLICATION DETAILS**

This application cannot be used to vary the licence so as to extend the period for which the licence has effect or to vary substantially the premises to which it relates. If you wish to make that type of change to the premises licence, you should make a new premises licence application under section 17 of the Licensing Act 2003.

I/we, as named in section 1, being the premises licence holder, apply to vary a premises licence under section 34 of the Licensing Act 2003 for the premises described in section 2 below.

* Premises Licence Number

Are you able to provide a postal address, OS map reference or description of the premises?

 Address OS map reference Description
Postal Address Of PremisesBuilding number or name Street District City or town County or administrative area Postcode Country **Premises Contact Details**Telephone number

Continued from previous page...

Non-domestic rateable
value of premises (£)

142,000

Section 3 of 18**VARIATION**Do you want the proposed
variation to have effect as
soon as possible? Yes NoDo you want the proposed variation to have effect in relation to the
introduction of the late night levy? Yes NoYou do not have to pay a fee if the only
purpose of the variation for which you are
applying is to avoid becoming liable to the
late night levy.If your proposed variation
would mean that 5,000 or
more people are expected to
attend the premises at any
one time, state the number
expected to attend**Describe Briefly The Nature Of The Proposed Variation**

Describe the premises. For example the type of premises, its general situation and layout and any other information which could be relevant to the licensing objectives. Where your application includes off-supplies of alcohol and you intend to provide a place for consumption of these off-supplies, you must include a description of where the place will be and its proximity to the premises.

A petrol forecourt store selling a broad range of groceries, household products and alcohol. Situated at 215 Selsdon Park Road, Croydon, CR2 8JH to be varied as follows:

1. Extension of the hours for the sale of alcohol to 24 hours daily.
2. To remove all the embedded conditions/restrictions in Annex 2 the licence.
3. To include in Annex 2 of the premises licence the conditions in boxes b to e of Section 16 of this application.

Section 4 of 18**PROVISION OF PLAYS**

See guidance on regulated entertainment

Will the schedule to provide plays be subject to change if this application to
vary is successful? Yes No**Section 5 of 18****PROVISION OF FILMS**

See guidance on regulated entertainment

Continued from previous page...

Will the schedule to provide films be subject to change if this application to vary is successful?

Yes No

Section 6 of 18

PROVISION OF INDOOR SPORTING EVENTS

See guidance on regulated entertainment

Will the schedule to provide indoor sporting events be subject to change if this application to vary is successful?

Yes No

Section 7 of 18

PROVISION OF BOXING OR WRESTLING ENTERTAINMENTS

See guidance on regulated entertainment

Will the schedule to provide boxing or wrestling entertainments be subject to change if this application to vary is successful?

Yes No

Section 8 of 18

PROVISION OF LIVE MUSIC

See guidance on regulated entertainment

Will the schedule to provide live music be subject to change if this application to vary is successful?

Yes No

Section 9 of 18

PROVISION OF RECORDED MUSIC

See guidance on regulated entertainment

Will the schedule to provide recorded music be subject to change if this application to vary is successful?

Yes No

Section 10 of 18

PROVISION OF PERFORMANCES OF DANCE

See guidance on regulated entertainment

Will the schedule to provide performances of dance be subject to change if this application to vary is successful?

Yes No

Section 11 of 18

PROVISION OF ANYTHING OF A SIMILAR DESCRIPTION TO LIVE MUSIC, RECORDED MUSIC OR PERFORMANCES OF DANCE

See guidance on regulated entertainment

Continued from previous page...

Will the schedule to provide anything similar to live music, recorded music or performances of dance be subject to change if this application to vary is successful?

Yes No

Section 12 of 18

PROVISION OF LATE NIGHT REFRESHMENT

Will the schedule to provide late night refreshment be subject to change if this application to vary is successful?

Yes No

Section 13 of 18

SUPPLY OF ALCOHOL

Will the schedule to supply alcohol be subject to change if this application to vary is successful?

Yes No

Standard Days And Timings

MONDAY

Start 00:00

End 24:00

Start

End

Provide timings in 24 hour clock (e.g., 16:00) and only give details for the days of the week when you intend the premises to be used for the activity.

TUESDAY

Start 00:00

End 24:00

Start

End

WEDNESDAY

Start 00:00

End 24:00

Start

End

THURSDAY

Start 00:00

End 24:00

Start

End

FRIDAY

Start 00:00

End 24:00

Start

End

SATURDAY

Start 00:00

End 24:00

Start

End

Continued from previous page...

SUNDAY

Start

End

Start

End

Will the sale of alcohol be for consumption?

- On the premises
 Off the premises
 Both

If the sale of alcohol is for consumption on the premises select on, if the sale of alcohol is for consumption away from the premises select off. If the sale of alcohol is for consumption on the premises and away from the premises select both.

State any seasonal variations.

For example (but not exclusively) where the activity will occur on additional days during the summer months.

Non-standard timings. Where the premises will be used for the supply of alcohol at different times from those listed above, list below.

For example (but not exclusively), where you wish the activity to go on longer on a particular day e.g. Christmas Eve.

Section 14 of 18

ADULT ENTERTAINMENT

Highlight any adult entertainment or services, activities, or other entertainment or matters ancillary to the use of the premises that may give rise to concern in respect of children.

Provide information about anything intended to occur at the premises or ancillary to the use of the premises which may give rise to concern in respect of children, regardless of whether you intend children to have access to the premises, for example (but not exclusively) nudity or semi-nudity, films for restricted age groups etc gambling machines etc.

The premises sell alcohol and other age restricted products.

Section 15 of 18

HOURS PREMISES ARE OPEN TO THE PUBLIC

Standard Days And Timings

MONDAY

Start

End

Start

End

Provide timings in 24 hour clock (e.g., 16:00) and only give details for the days of the week when you intend the premises to be used for the activity.

Continued from previous page...

TUESDAY

Start	<input type="text" value="00:00"/>	End	<input type="text" value="24:00"/>
Start	<input type="text"/>	End	<input type="text"/>

WEDNESDAY

Start	<input type="text" value="00:00"/>	End	<input type="text" value="24:00"/>
Start	<input type="text"/>	End	<input type="text"/>

THURSDAY

Start	<input type="text" value="00:00"/>	End	<input type="text" value="24:00"/>
Start	<input type="text"/>	End	<input type="text"/>

FRIDAY

Start	<input type="text" value="00:00"/>	End	<input type="text" value="24:00"/>
Start	<input type="text"/>	End	<input type="text"/>

SATURDAY

Start	<input type="text" value="00:00"/>	End	<input type="text" value="24:00"/>
Start	<input type="text"/>	End	<input type="text"/>

SUNDAY

Start	<input type="text" value="00:00"/>	End	<input type="text" value="24:00"/>
Start	<input type="text"/>	End	<input type="text"/>

State any seasonal variations.

For example (but not exclusively) where the activity will occur on additional days during the summer months.

Non standard timings. Where you intend to use the premises to be open to the members and guests at different times from those listed above, list below.

For example (but not exclusively), where you wish the activity to go on longer on a particular day e.g. Christmas Eve.

Continued from previous page...

Identify those conditions currently imposed on the licence which you believe could be removed as a consequence of the proposed variation you are seeking.

1. The embedded conditions/restrictions set out in Annex 2 of the licence.
2. The hours for the sale of alcohol are currently restricted to 0800 to 2300 daily.

The above conditions and restrictions would be removed as a consequence of the proposed variation.

- I have enclosed the premises licence
- I have enclosed the relevant part of the premises licence

Reasons why I have failed to enclose the premises licence or relevant part of premises licence.

Section 16 of 18

LICENSING OBJECTIVES

Describe the steps you intend to take to promote the four licensing objectives:

a) General – all four licensing objectives (b,c,d,e)

List here steps you will take to promote all four licensing objectives together.

b) The prevention of crime and disorder

1. A digital CCTV system will be installed, or the existing system maintained, such system to be fit for the purpose (and to be to the reasonable satisfaction of the police).
2. The CCTV system shall be capable of producing immediate copies on site. Copies of recordings will either be recorded digitally on to CD/DVD or other equivalent medium.
3. Any recording will be retained and stored in a suitable and secure manner for a minimum of 31 days and shall be made available, subject to compliance with Data Protection legislation, to the police for inspection on request.
4. The precise positions of the cameras may be agreed, subject to compliance with Data Protection legislation, with the police from time to time.
5. The system will display, on any recording, the correct time and date of the recording.
6. The CCTV system will be maintained and fully operational throughout the hours that the premises are open for any licensable activity.

c) Public safety

The premises licence holder will at all times maintain adequate levels of staff. Such staff levels will be disclosed, on request, to the licensing authority and police.

Continued from previous page...

d) The prevention of public nuisance

Adequate waste receptacles for use by customers shall be provided in and immediately outside the premises.

e) The protection of children from harm

The premises licence holder will ensure that an age verification policy will apply to the premises whereby all cashiers will be trained to ask any customer attempting to purchase alcohol, who appears to be under the age of 25 years (or older if the licence holder so elects) to produce, before being sold alcohol, identification being a passport or photocard driving licence bearing a holographic mark or other form of identification that complies with any mandatory condition that may apply to this licence.

Section 17 of 18

NOTES ON REGULATED ENTERTAINMENT

A3

Sent: 29 May 2018 22:20

To: Moir, Graham <[redacted]>

Subject: FW: FW: Licensing Applications Received Week 18.. Wards Purley Oaks & Riddlesdown and Selsdon & Addington Village

Dear Graham,

I would like to register objections to this licensing application at Selsdon Park Road. Residents do not want to have alcohol for sale 24 hours a day as it will encourage antisocial behaviour in the area. People will come to the shop to buy alcohol, perhaps from further afield, and they are likely to cause a public nuisance in the area.

Thanks

Councillor Helen Pollard
Selsdon & Addington Village Ward

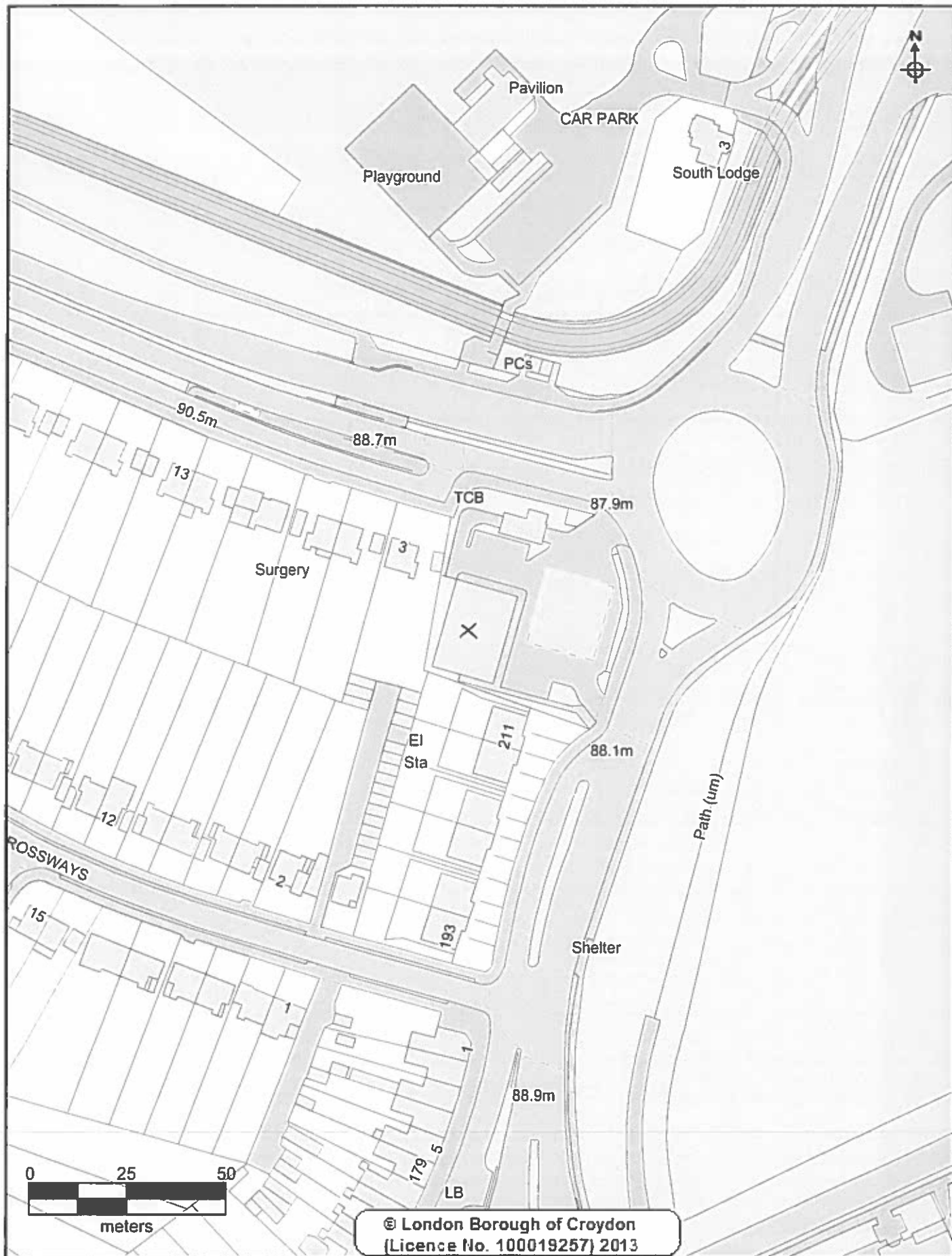

CROYDON
www.croydon.gov.uk

Crown Copyright Ordnance Survey (License No: 100019257) 2011

London Borough Croydon

Scale 1:1250

15-Jun-2018

X = 211 SELSDON PARK ROAD



This page is intentionally left blank